

Türgriffe

Türgriffe für Holztüren

Türgriffe für Glastüren

Türgriffe für Metalltüren

Türgriffe für Rahmentüren

Pull handles

Pull handles for timber doors

Pull handles for glass doors

Pull handles for metal doors

Pull handles for narrow stile doors

Kurzzeichen

ER Edelstahl Rostfrei
ZU Zubehör

GE Griff, einzeln
GP Griff, Paar

Identification

ER Stainless steel
ZU Accessories

GE Single pull handle
GP Pair of pull handle

Bestellnummern-System

Explanation of product code

ER. GEO. 224. 0400

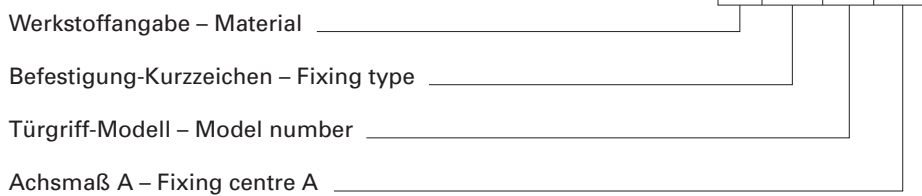

Modellübersicht Türgriffe – Edelstahl

Vieler pull handles – stainless steel

095



4.02-9

220



4.07-9

225



4.12-9

096



4.03-9

221

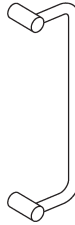

4.08-9

226

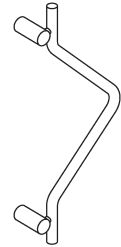

4.13-9

211



4.04-9

222



4.09-9

230
240



4.14-9

212

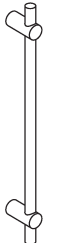

4.05-9

223



4.10-9

231



4.15-9

217



4.06-9

224



4.11-9

232



4.16-9

Modellübersicht Türgriffe – Edelstahl

Vieler pull handles – stainless steel

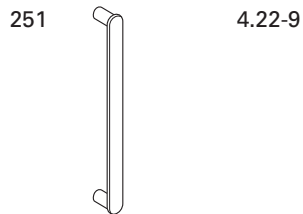
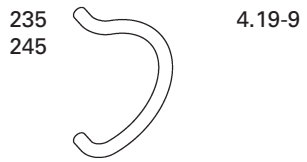
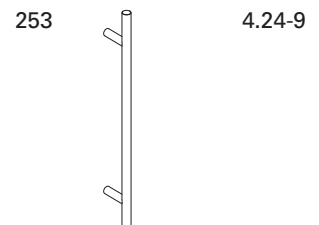
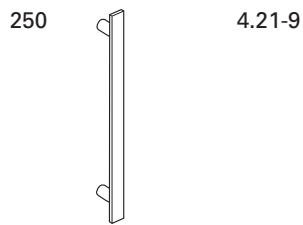
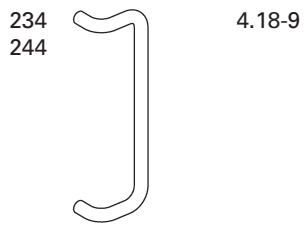
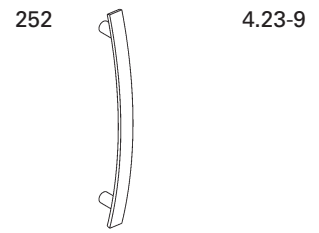
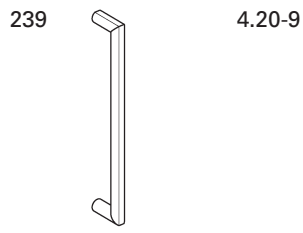
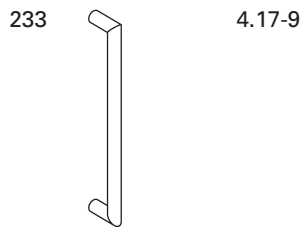

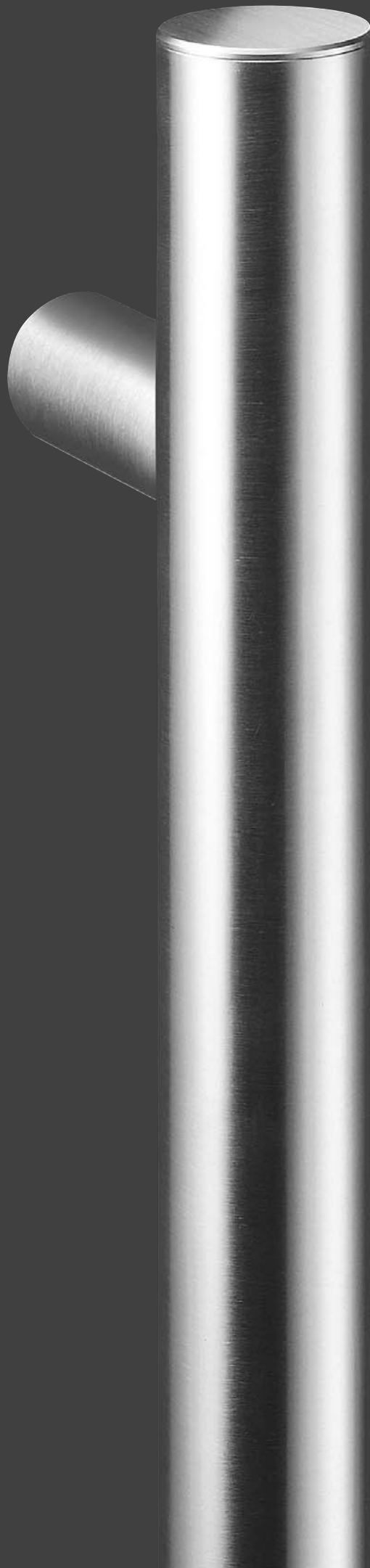

Vieler Türgriff 095 – Edelstahl

Hochwertiges Material mit matt gebürsteter, pflegeleichter Oberfläche. Verdeckte Beschlagverschraubung. Verarbeitungsfreundliches Befestigungsmaterial.

Vieler pull handle 095 – stainless steel

Maintenance free brushed satin stainless steel. Supplied with relevant concealed fixings.

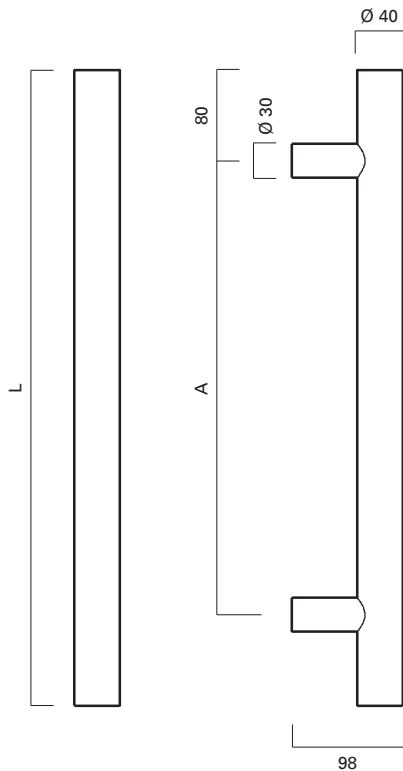

A = 500 – 2500
L = A + 160

Die Befestigung des Innen-Türgriffs mit dem Gewindestift M 6 kann je nach Modell von unten, oben oder seitlich erfolgen.

The fixing of the inside pull handle with fixing bolt M 6 can occur to model from below, on top or at the side.

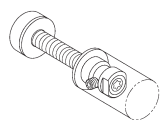

GE0
Metalltür
Metal door

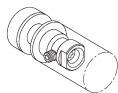

GE2
Glastür
Glass door

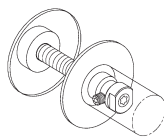

GE4
Holztür
Wooden door

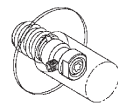

GE6
Holztür/
Einschraubmuttern
Wooden door/
threaded bush

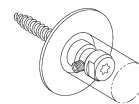

GE7
Holztür/
Holzschrauben
Wooden door/
Wood screw

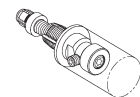

GE10
Rahmentür
mit mehreren Kammern
Metal door/
different channels

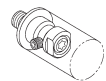

GE12
Rahmentür/
Kerneinlagen
Metal door/
solid metal core

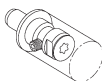

GE13
Rahmentür/
Blindnietmuttern
Metal door/
threaded bush

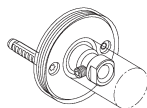

GE17
Rosettenbefestigung
Rose fixing

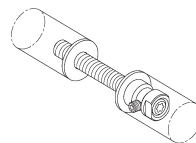

GP1
Metalltür
Metal door

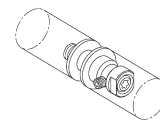

GP3
Glastür
Glass door

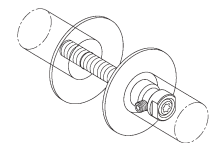

GP5
Holztür
Wooden door

Produktfamilie
Product family

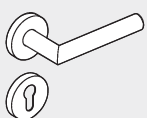

Türdrücker 112
Lever handle 112
2.03-9

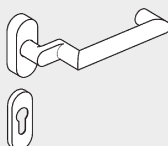

Rahmentür-Drücker RT 114
Narrow stile lever handle RT 114
2.32-9



Fenstergriff 612
Window handle 612
3.12-9

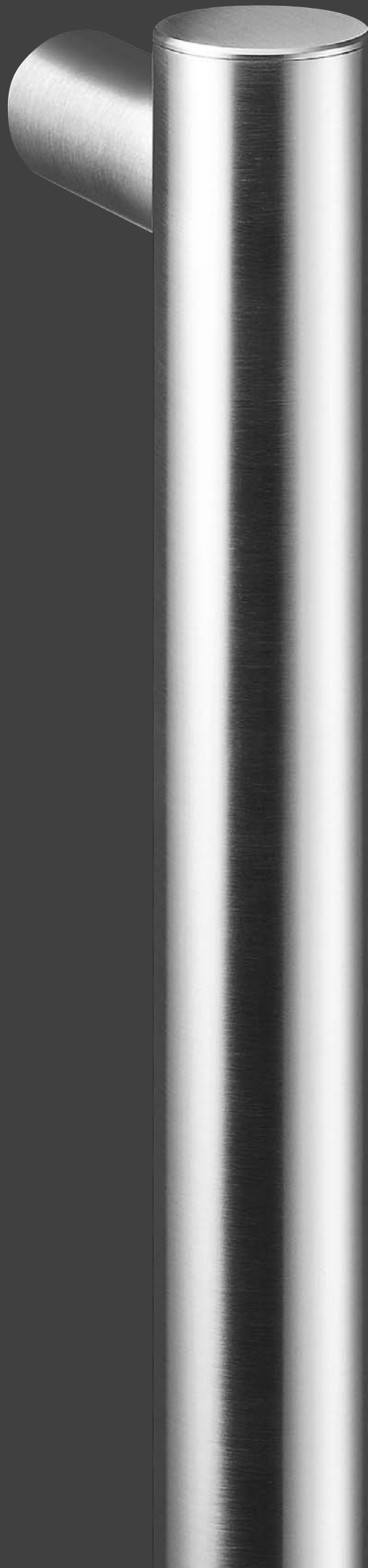

Vieler Türgriff 096 – Edelstahl

Hochwertiges Material mit matt gebürsteter, pflegeleichter Oberfläche. Verdeckte Beschlagverschraubung. Verarbeitungsfreundliches Befestigungsmaterial.

Vieler pull handle 096 – stainless steel

Maintenance free brushed satin stainless steel. Supplied with relevant concealed fixings.

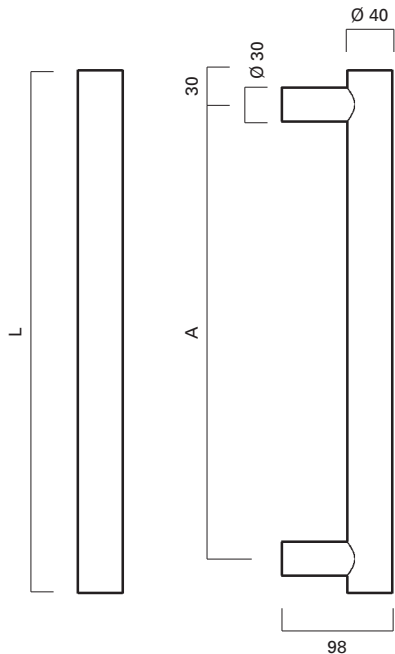

A = 500 – 2500
L = A + 60

Die Befestigung des Innen-Türgriffs mit dem Gewindestift M 6 kann je nach Modell von unten, oben oder seitlich erfolgen.

The fixing of the inside pull handle with fixing bolt M 6 can occur to model from below, on top or at the side.

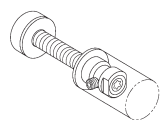

GE0
Metalltür
Metal door

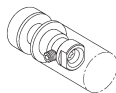

GE2
Glastür
Glass door

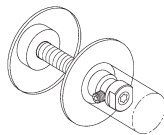

GE4
Holztür
Wooden door

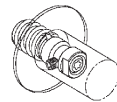

GE6
Holztür/
Einschraubmuttern
Wooden door/
threaded bush

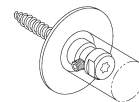

GE7
Holztür/
Holzschrauben
Wooden door/
Wood screw

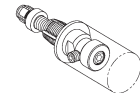

GE10
Rahmentür
mit mehreren Kammern
Metal door/
different channels

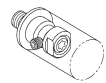

GE12
Rahmentür/
Kerneinlagen
Metal door/
solid metal core

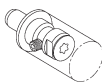

GE13
Rahmentür/
Blindnietmuttern
Metal door/
threaded bush

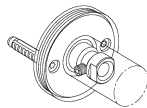

GE17
Rosettenbefestigung
Rose fixing

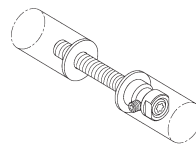

GP1
Metalltür
Metal door

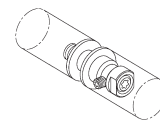

GP3
Glastür
Glass door

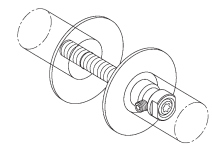

GP5
Holztür
Wooden door

Produktfamilie
Product family

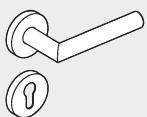

Türdrücker 112
Lever handle 112
2.03-9

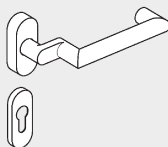

Rahmentür-Drücker RT 114
Narrow stile lever handle RT 114
2.32-9



Fenstergriff 612
Window handle 612
3.12-9



Vieler Türgriff 211 – Edelstahl
Vieler pull handle 211 – stainless steel

Vieler Türgriff 211 – Edelstahl

Hochwertiges Material mit matt gebürsteter, pflegeleichter Oberfläche. Verdeckte Beschlagverschraubung. Verarbeitungsfreundliches Befestigungsmaterial.

Vieler pull handle 211 – stainless steel

Maintenance free brushed satin stainless steel. Supplied with relevant concealed fixings.

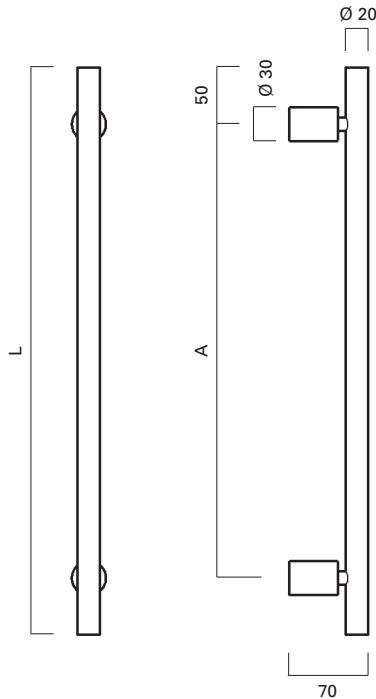

A = 300 – 1250
L = A + 100

Die Befestigung des Innen-Türgriffs mit dem Gewindestift M 6 kann je nach Modell von unten, oben oder seitlich erfolgen.

The fixing of the inside pull handle with fixing bolt M 6 can occur to model from below, on top or at the side.

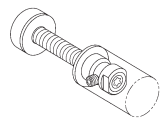

GE0
Metalltür
Metal door

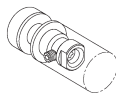

GE2
Glastür
Glass door

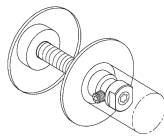

GE4
Holztür
Wooden door

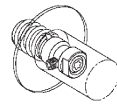

GE6
Holztür/
Einschraubmuttern
Wooden door/
threaded bush

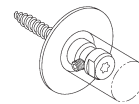

GE7
Holztür/
Holzschrauben
Wooden door/
Wood screw

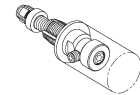

GE10
Rahmentür
mit mehreren Kammern
Metal door/
different channels

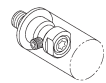

GE12
Rahmentür/
Kerneinlagen
Metal door/
solid metal core

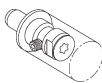

GE13
Rahmentür/
Blindnietmuttern
Metal door/
threaded bush

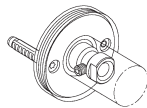

GE17
Rosettenbefestigung
Rose fixing

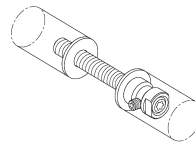

GP1
Metalltür
Metal door

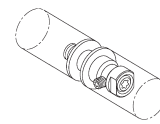

GP3
Glastür
Glass door

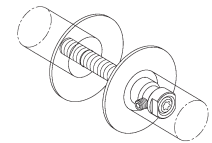

GP5
Holztür
Wooden door

Produktfamilie
Product family

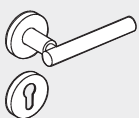

Türdrücker 124
Lever handle 124
2.07-9

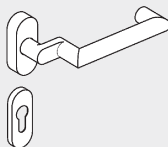

Rahmentür-Drücker RT 114
Narrow stile lever handle RT 114
2.32-9



Fenstergriff 124
Window handle 124
3.04-9

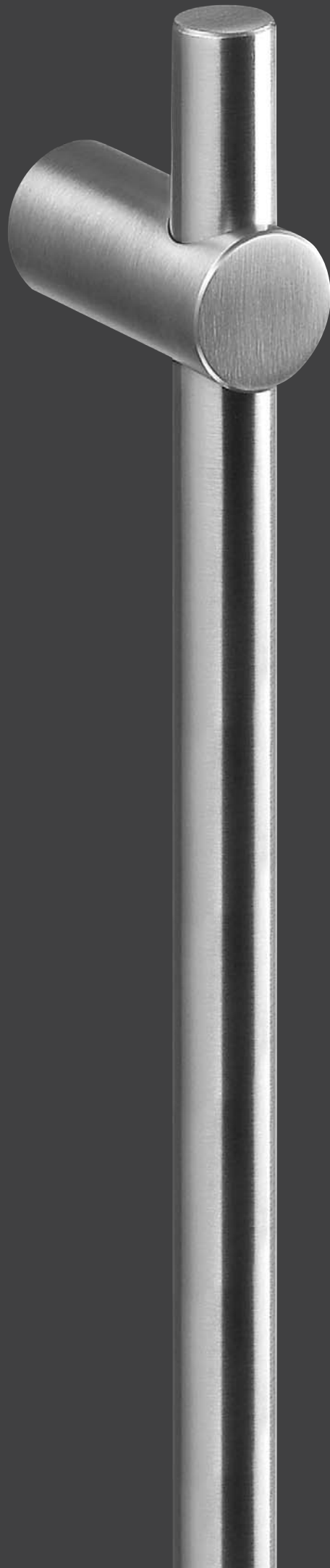

Vieler Türgriff 212 – Edelstahl
Vieler pull handle 212 – stainless steel

Vieler Türgriff 212 – Edelstahl

Hochwertiges Material mit matt gebürsteter, pflegeleichter Oberfläche. Verdeckte Beschlagverschraubung. Verarbeitungsfreundliches Befestigungsmaterial.

Vieler pull handle 212 – stainless steel

Maintenance free brushed satin stainless steel. Supplied with relevant concealed fixings.

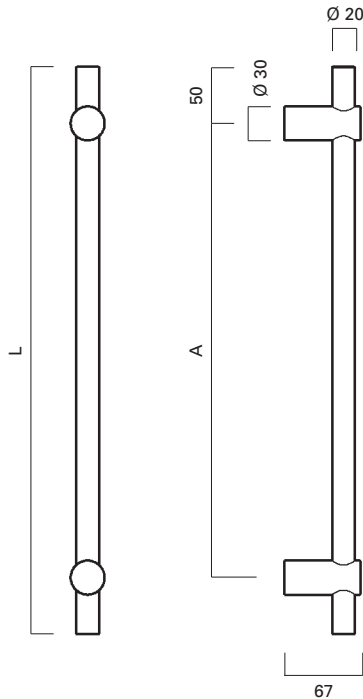

A = 300 – 1250
L = A + 100

Die Befestigung des Innen-Türgriffs mit dem Gewindestift M 6 kann je nach Modell von unten, oben oder seitlich erfolgen.

The fixing of the inside pull handle with fixing bolt M 6 can occur to model from below, on top or at the side.

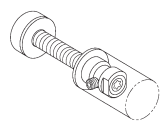

GE0
Metalltür
Metal door

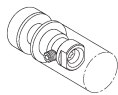

GE2
Glastür
Glass door

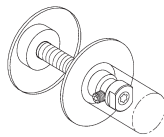

GE4
Holztür
Wooden door

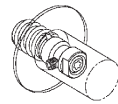

GE6
Holztür/
Einschraubmuttern
Wooden door/
threaded bush

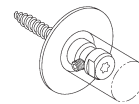

GE7
Holztür/
Holzschrauben
Wooden door/
Wood screw

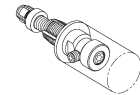

GE10
Rahmentür
mit mehreren Kammern
Metal door/
different channels

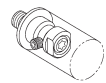

GE12
Rahmentür/
Kerneinlagen
Metal door/
solid metal core

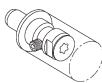

GE13
Rahmentür/
Blindnietmuttern
Metal door/
threaded bush

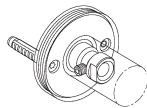

GE17
Rosettenbefestigung
Rose fixing

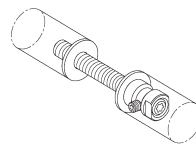

GP1
Metalltür
Metal door

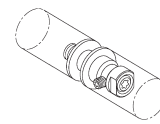

GP3
Glastür
Glass door

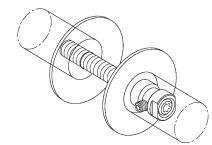

GP5
Holztür
Wooden door

Produktfamilie
Product family

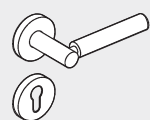

Türdrücker 121
Lever handle 121
2.06-9

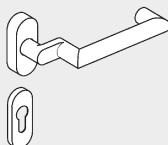

Rahmentür-Drücker RT 114
Narrow stile lever handle RT 114
2.32-9

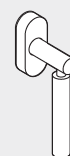

Fenstergriff 121
Window handle 121
3.03-9

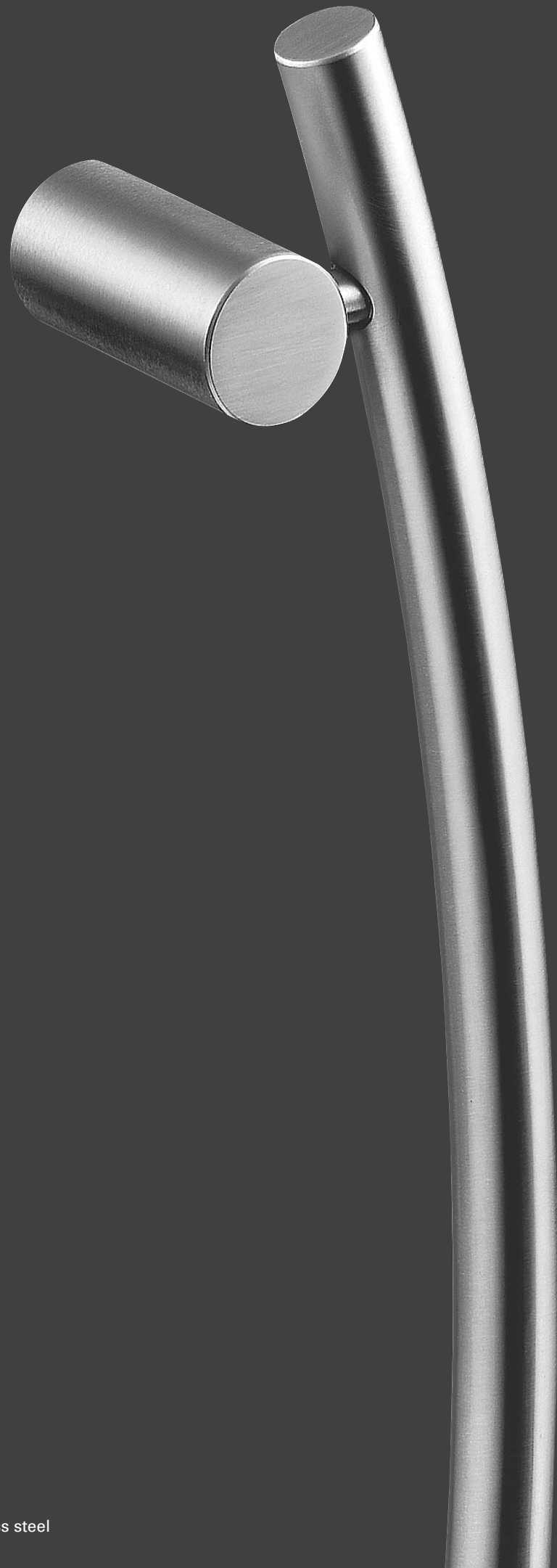

Vieler Türgriff 217 – Edelstahl
Vieler pull handle 217 – stainless steel

Vieler Türgriff 217 – Edelstahl

Hochwertiges Material mit matt gebürsteter, pflegeleichter Oberfläche. Verdeckte Beschlagverschraubung. Verarbeitungsfreundliches Befestigungsmaterial.

Vieler pull handle 217 – stainless steel

Maintenance free brushed satin stainless steel. Supplied with relevant concealed fixings.

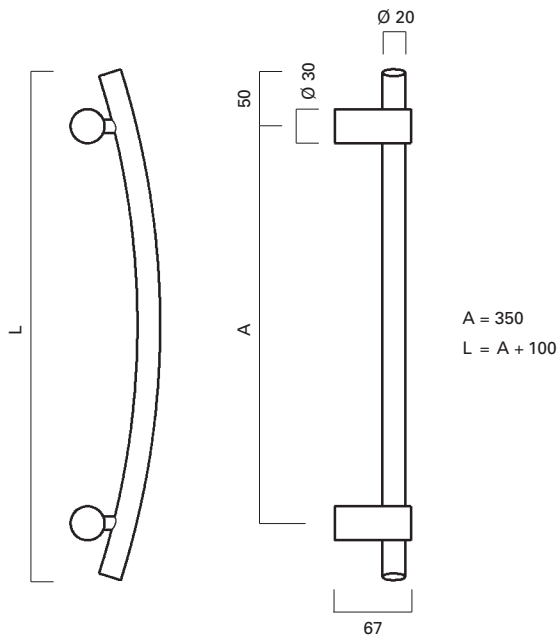

Die Befestigung des Innen-Türgriffs mit dem Gewindestift M 6 kann je nach Modell von unten, oben oder seitlich erfolgen.

The fixing of the inside pull handle with fixing bolt M 6 can occur to model from below, on top or at the side.

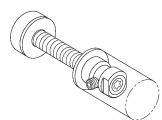

GE0
Metalltür
Metal door

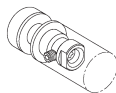

GE2
Glastür
Glass door

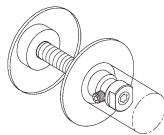

GE4
Holztür
Wooden door

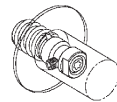

GE6
Holztür/
Einschraubmuttern
Wooden door/
threaded bush

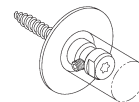

GE7
Holztür/
Holzschrauben
Wooden door/
Wood screw

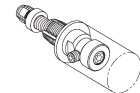

GE10
Rahmentür
mit mehreren Kammern
Metal door/
different channels

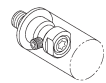

GE12
Rahmentür/
Kerneinlagen
Metal door/
solid metal core

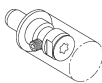

GE13
Rahmentür/
Blindnietmuttern
Metal door/
threaded bush

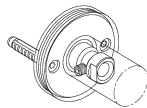

GE17
Rosettenbefestigung
Rose fixing

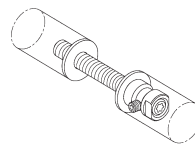

GP1
Metalltür
Metal door

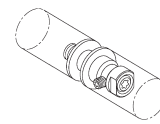

GP3
Glastür
Glass door

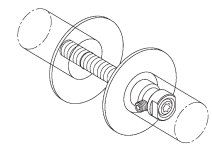

GP5
Holztür
Wooden door

Produktfamilie
Product family

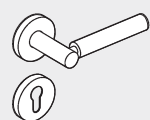

Türdrücker 121
Lever handle 121
2.06-9

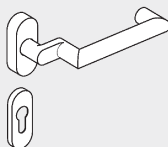

Rahmentür-Drücker RT 114
Narrow stile lever handle RT 114
2.32-9



Fenstergriff 121
Window handle 121
3.03-9

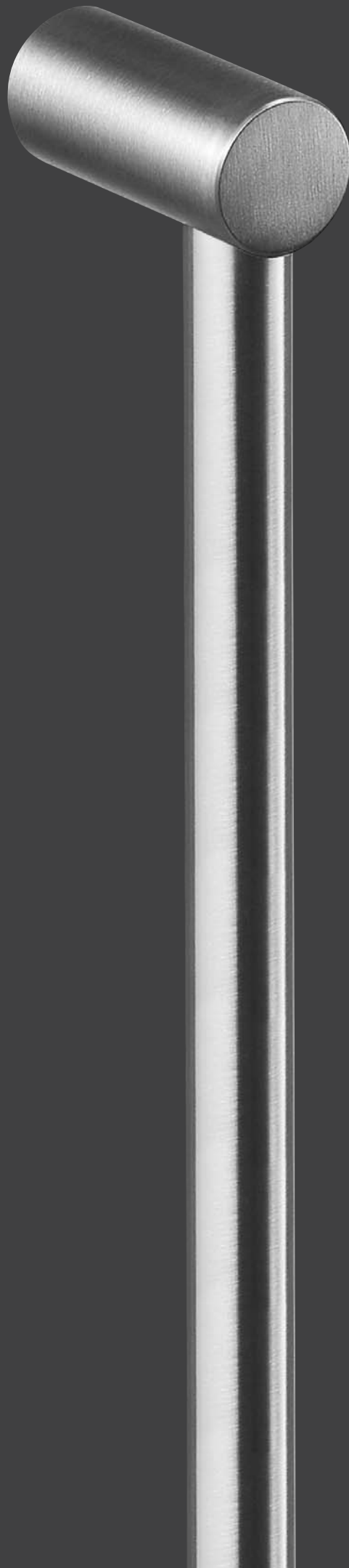

Vieler Türgriff 220 – Edelstahl
Vieler pull handle 220 – stainless steel

Vieler Türgriff 220 – Edelstahl

Hochwertiges Material mit matt gebürsteter, pflegeleichter Oberfläche. Verdeckte Beschlagverschraubung. Verarbeitungsfreundliches Befestigungsmaterial.

Vieler pull handle 220 – stainless steel

Maintenance free brushed satin stainless steel. Supplied with relevant concealed fixings.

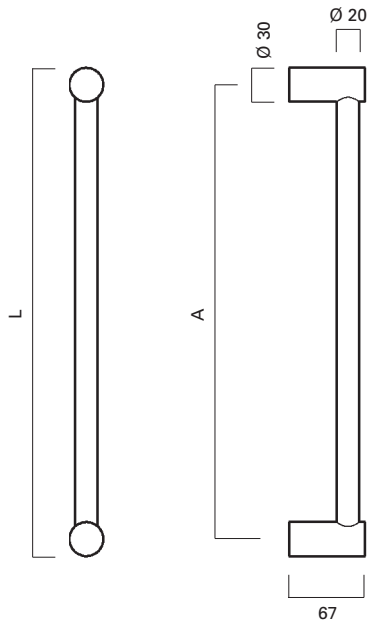

A = 300 – 1250
> 500 massiv / solid
L = A + 30

Die Befestigung des Innen-Türgriffs mit dem Gewindestift M6 kann je nach Modell von unten, oben oder seitlich erfolgen.

The fixing of the inside pull handle with fixing bolt M6 can occur to model from below, on top or at the side.

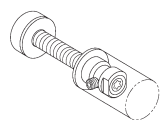

GE0
Metalltür
Metal door

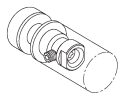

GE2
Glastür
Glass door

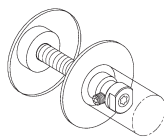

GE4
Holztür
Wooden door

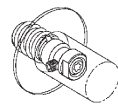

GE6
Holztür/
Einschraubmuttern
Wooden door/
threaded bush

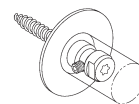

GE7
Holztür/
Holzschrauben
Wooden door/
Wood screw

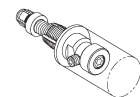

GE10
Rahmentür
mit mehreren Kammern
Metal door/
different channels

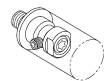

GE12
Rahmentür/
Kerneinlagen
Metal door/
solid metal core

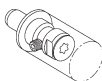

GE13
Rahmentür/
Blindnietmuttern
Metal door/
threaded bush

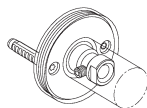

GE17
Rosettenbefestigung
Rose fixing

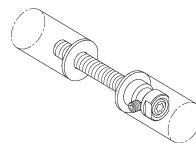

GP1
Metalltür
Metal door

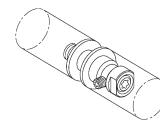

GP3
Glastür
Glass door

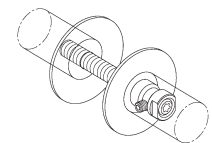

GP5
Holztür
Wooden door

Produktfamilie
Product family

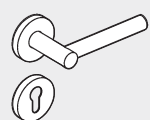

Türdrücker 134
Lever handle 134
2.10-9

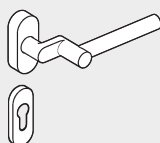

Rahmentür-Drücker RT 134
Narrow stile lever handle RT 134
2.34-9



Fenstergriff 134
Window handle 134
3.07-9



Vieler Türgriff 221 – Edelstahl
Vieler pull handle 221 – stainless steel

Vieler Türgriff 221 – Edelstahl

Hochwertiges Material mit matt gebürsteter, pflegeleichter Oberfläche. Verdeckte Beschlagverschraubung. Verarbeitungsfreundliches Befestigungsmaterial.

Vieler pull handle 221 – stainless steel

Maintenance free brushed satin stainless steel. Supplied with relevant concealed fixings.

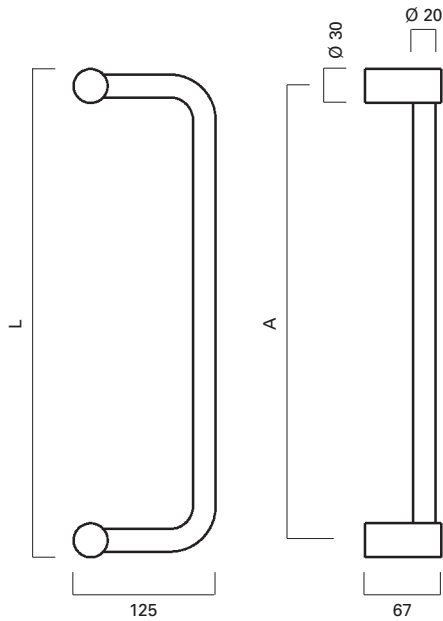

A = 300 - 1250
>500 massiv / solid
L = A + 30

Die Befestigung des Innen-Türgriffs mit dem Gewindestift M 6 kann je nach Modell von unten, oben oder seitlich erfolgen.

The fixing of the inside pull handle with fixing bolt M 6 can occur to model from below, on top or at the side.

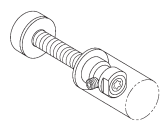

GE0
Metalltür
Metal door

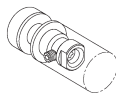

GE2
Glastür
Glass door

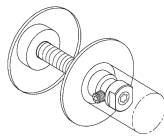

GE4
Holztür
Wooden door

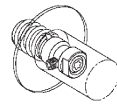

GE6
Holztür/
Einschraubmuttern
Wooden door/
threaded bush

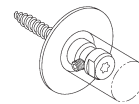

GE7
Holztür/
Holzschrauben
Wooden door/
Wood screw

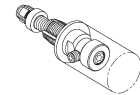

GE10
Rahmentür
mit mehreren Kammern
Metal door/
different channels

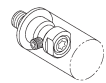

GE12
Rahmentür/
Kerneinlagen
Metal door/
solid metal core

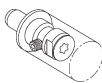

GE13
Rahmentür/
Blindnietmuttern
Metal door/
threaded bush

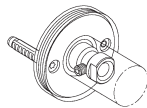

GE17
Rosettenbefestigung
Rose fixing

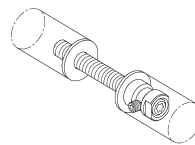

GP1
Metalltür
Metal door

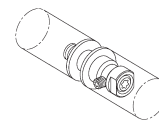

GP3
Glastür
Glass door

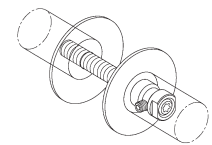

GP5
Holztür
Wooden door

Produktfamilie
Product family

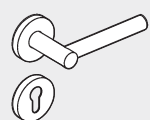

Türdrücker 134
Lever handle 134
2.10-9

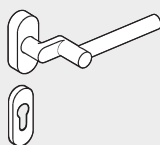

Rahmentür-Drücker RT 134
Narrow stile lever handle RT 134
2.34-9



Fenstergriff 134
Window handle 134
3.07-9

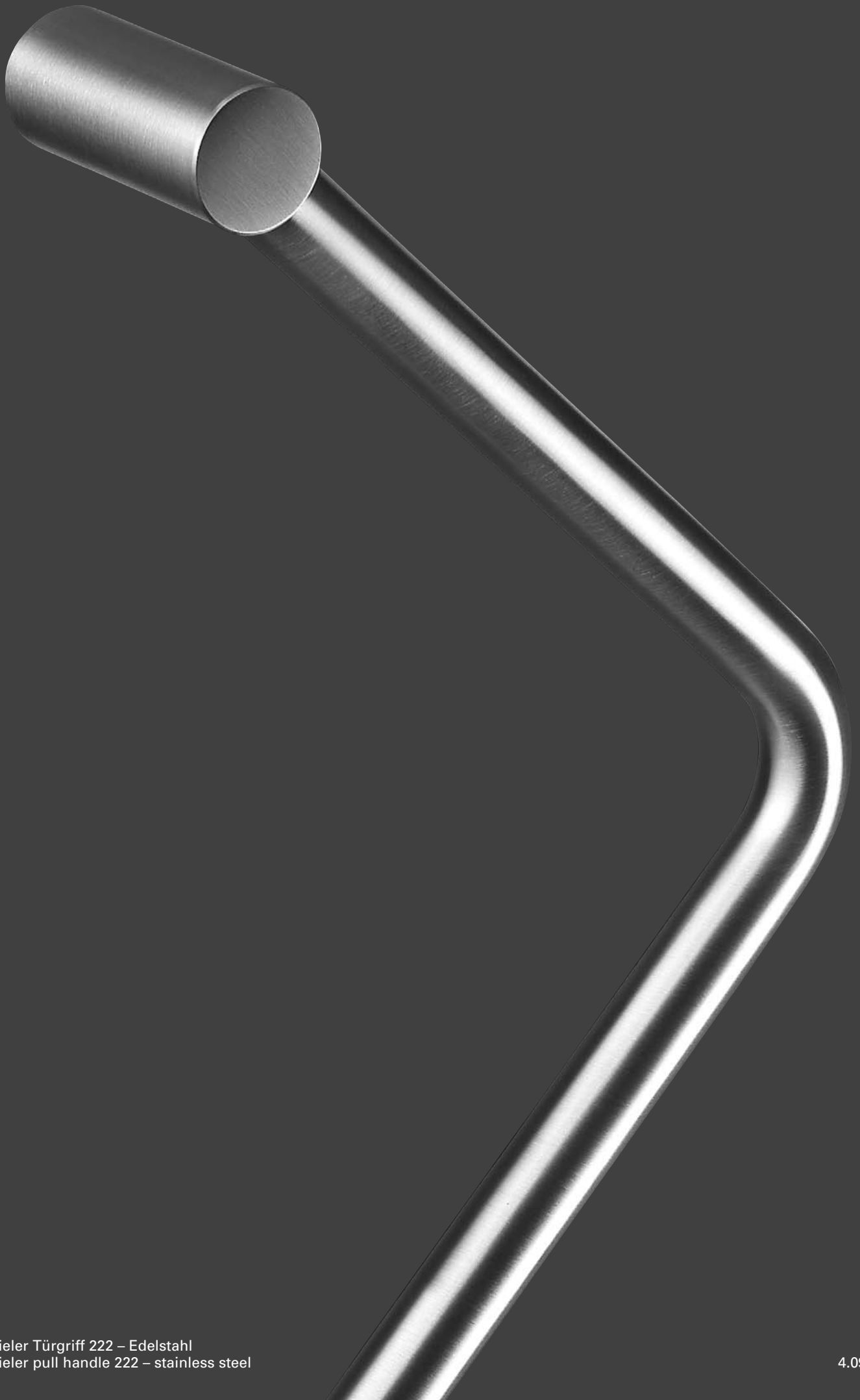

Vieler Türgriff 222 – Edelstahl
Vieler pull handle 222 – stainless steel

Vieler Türgriff 222 – Edelstahl

Hochwertiges Material mit matt gebürsteter, pflegeleichter Oberfläche. Verdeckte Beschlagverschraubung. Verarbeitungsfreundliches Befestigungsmaterial.

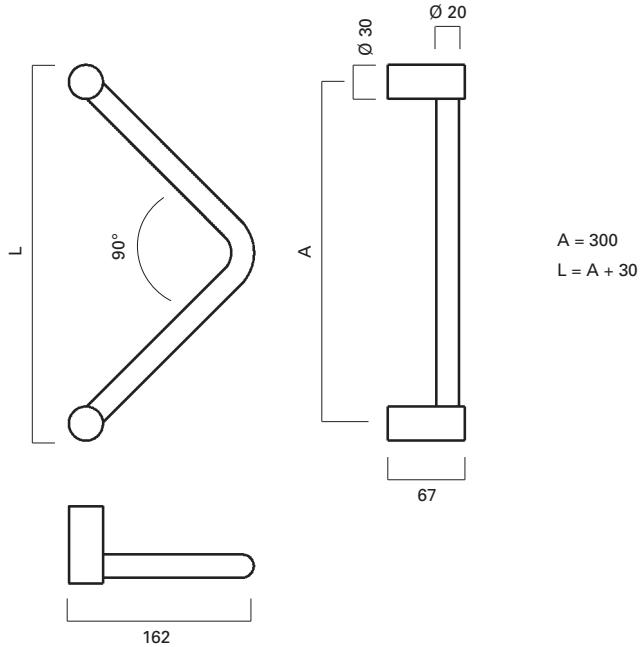

Vieler pull handle 222 – stainless steel

Maintenance free brushed satin stainless steel. Supplied with relevant concealed fixings.

Die Befestigung des Innen-Türgriffs mit dem Gewindestift M 6 kann je nach Modell von unten, oben oder seitlich erfolgen.

The fixing of the inside pull handle with fixing bolt M 6 can occur to model from below, on top or at the side.

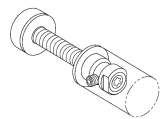

GE0
Metalltür
Metal door

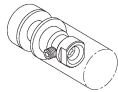

GE2
Glastür
Glass door

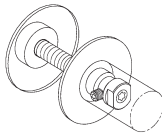

GE4
Holztür
Wooden door

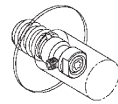

GE6
Holztür/
Einschraubmuttern
Wooden door/
threaded bush

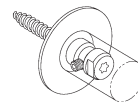

GE7
Holztür/
Holzschrauben
Wooden door/
Wood screw

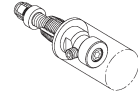

GE10
Rahmentür
mit mehreren Kammern
Metal door/
different channels

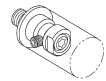

GE12
Rahmentür/
Kerneinlagen
Metal door/
solid metal core

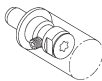

GE13
Rahmentür/
Blindnietmuttern
Metal door/
threaded bush

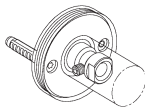

GE17
Rosettenbefestigung
Rose fixing

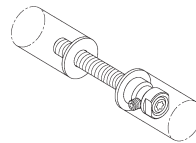

GP1
Metalltür
Metal door

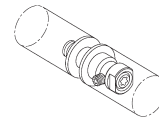

GP3
Glastür
Glass door

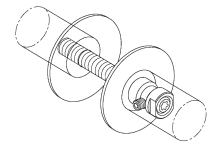

GP5
Holztür
Wooden door

Produktfamilie
Product family

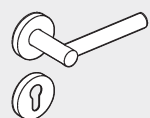

Türdrücker 134
Lever handle 134
2.10-9

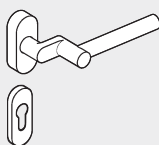

Rahmentür-Drücker RT 134
Narrow stile lever handle RT 134
2.34-9



Fenstergriff 134
Window handle 134
3.07-9



Vieler Türgriff 223 – Edelstahl
Vieler pull handle 223 – stainless steel

Vieler Türgriff 223 – Edelstahl

Hochwertiges Material mit matt gebürsteter, pflegeleichter Oberfläche. Verdeckte Beschlagverschraubung. Verarbeitungsfreundliches Befestigungsmaterial.

Vieler pull handle 223 – stainless steel

Maintenance free brushed satin stainless steel. Supplied with relevant concealed fixings.

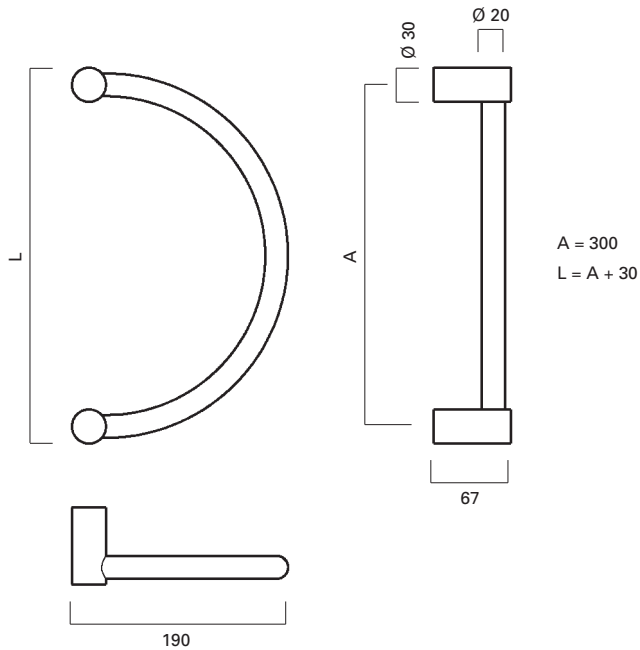

Die Befestigung des Innen-Türgriffs mit dem Gewindestift M 6 kann je nach Modell von unten, oben oder seitlich erfolgen.

The fixing of the inside pull handle with fixing bolt M 6 can occur to model from below, on top or at the side.

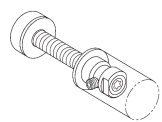

GE0
Metalltür
Metal door

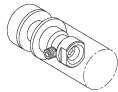

GE2
Glastür
Glass door

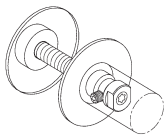

GE4
Holztür
Wooden door

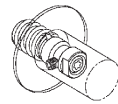

GE6
Holztür/
Einschraubmuttern
Wooden door/
threaded bush

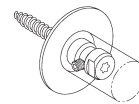

GE7
Holztür/
Holzschrauben
Wooden door/
Wood screw

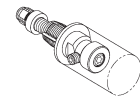

GE10
Rahmentür
mit mehreren Kammern
Metal door/
different channels

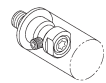

GE12
Rahmentür/
Kerneinlagen
Metal door/
solid metal core

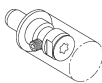

GE13
Rahmentür/
Blindnietmuttern
Metal door/
threaded bush

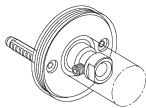

GE17
Rosettenbefestigung
Rose fixing

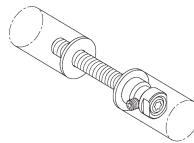

GP1
Metalltür
Metal door

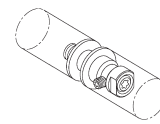

GP3
Glastür
Glass door

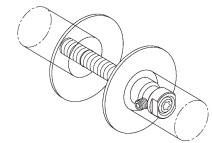

GP5
Holztür
Wooden door

Produktfamilie
Product family

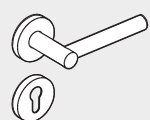

Türdrücker 134
Lever handle 134
2.10-9

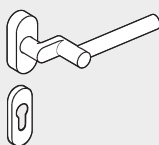

Rahmentür-Drücker RT 134
Narrow stile lever handle RT 134
2.34-9



Fenstergriff 134
Window handle 134
3.07-9

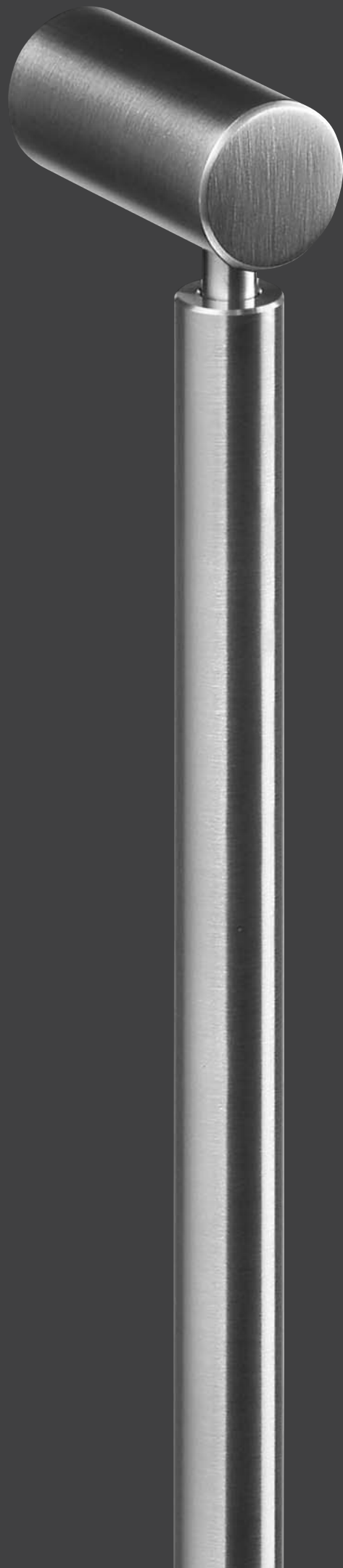

Vieler Türgriff 224 – Edelstahl
Vieler pull handle 224 – stainless steel

Vieler Türgriff 224 – Edelstahl

Hochwertiges Material mit matt gebürsteter, pflegeleichter Oberfläche. Verdeckte Beschlagverschraubung. Verarbeitungsfreundliches Befestigungsmaterial.

Vieler pull handle 224 – stainless steel

Maintenance free brushed satin stainless steel. Supplied with relevant concealed fixings.

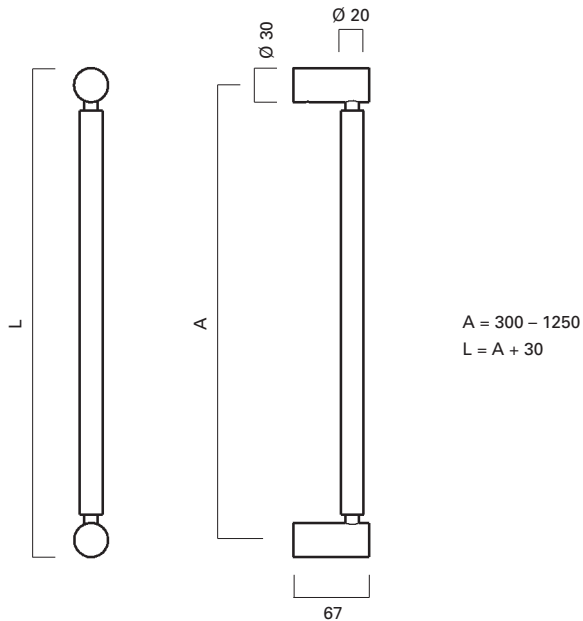

Die Befestigung des Innen-Türgriffs mit dem Gewindestift M 6 kann je nach Modell von unten, oben oder seitlich erfolgen.

The fixing of the inside pull handle with fixing bolt M 6 can occur to model from below, on top or at the side.

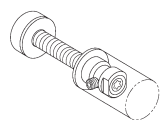

GE0
Metalltür
Metal door

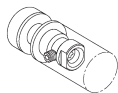

GE2
Glastür
Glass door

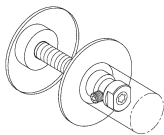

GE4
Holztür
Wooden door

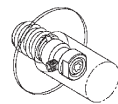

GE6
Holztür/
Einschraubmuttern
Wooden door/
threaded bush

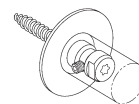

GE7
Holztür/
Holzschrauben
Wooden door/
Wood screw

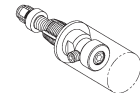

GE10
Rahmentür
mit mehreren Kammern
Metal door/
different channels

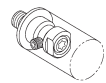

GE12
Rahmentür/
Kerneinlagen
Metal door/
solid metal core

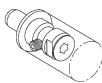

GE13
Rahmentür/
Blindnietmuttern
Metal door/
threaded bush

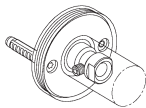

GE17
Rosettenbefestigung
Rose fixing

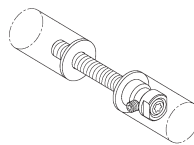

GP1
Metalltür
Metal door

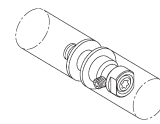

GP3
Glastür
Glass door

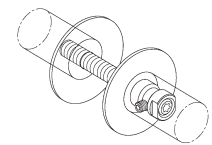

GP5
Holztür
Wooden door

Produktfamilie
Product family

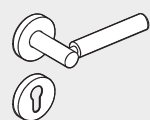

Türdrücker 121
Lever handle 121
2.06-9

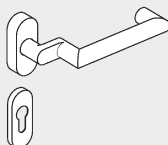

Rahmentür-Drücker RT 114
Narrow stile lever handle RT 114
2.32-9



Fenstergriff 121
Window handle 121
3.03-9



Vieler Türgriff 225 – Edelstahl

Hochwertiges Material mit matt gebürsteter, pflegeleichter Oberfläche. Verdeckte Beschlagverschraubung. Verarbeitungsfreundliches Befestigungsmaterial.

Vieler pull handle 225 – stainless steel

Maintenance free brushed satin stainless steel. Supplied with relevant concealed fixings.

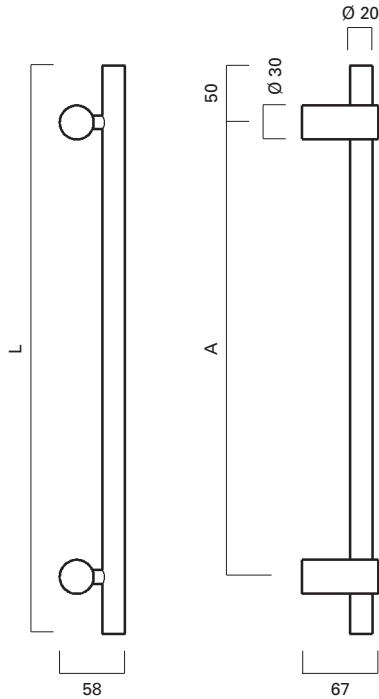

A = 300 – 1250
L = A + 100

Die Befestigung des Innen-Türgriffs mit dem Gewindestift M 6 kann je nach Modell von unten, oben oder seitlich erfolgen.

The fixing of the inside pull handle with fixing bolt M 6 can occur to model from below, on top or at the side.

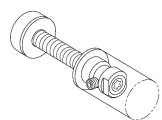

GE0
Metalltür
Metal door

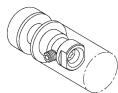

GE2
Glastür
Glass door

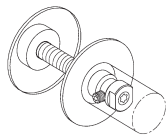

GE4
Holztür
Wooden door

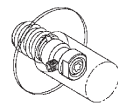

GE6
Holztür/
Einschraubmuttern
Wooden door/
threaded bush

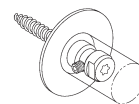

GE7
Holztür/
Holzschrauben
Wooden door/
Wood screw

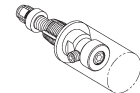

GE10
Rahmentür
mit mehreren Kammern
Metal door/
different channels

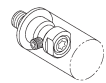

GE12
Rahmentür/
Kerneinlagen
Metal door/
solid metal core

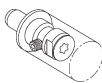

GE13
Rahmentür/
Blindnietmuttern
Metal door/
threaded bush

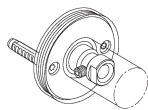

GE17
Rosettenbefestigung
Rose fixing

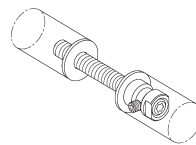

GP1
Metalltür
Metal door

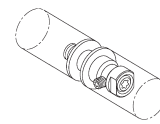

GP3
Glastür
Glass door

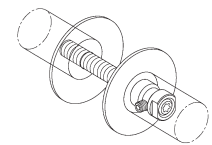

GP5
Holztür
Wooden door

Produktfamilie
Product family

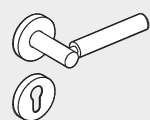

Türdrücker 121
Lever handle 121
2.06-9

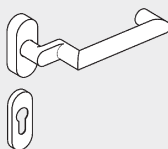

Rahmentür-Drücker RT 114
Narrow stile lever handle RT 114
2.32-9

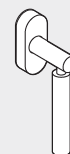

Fenstergriff 121
Window handle 121
3.03-9

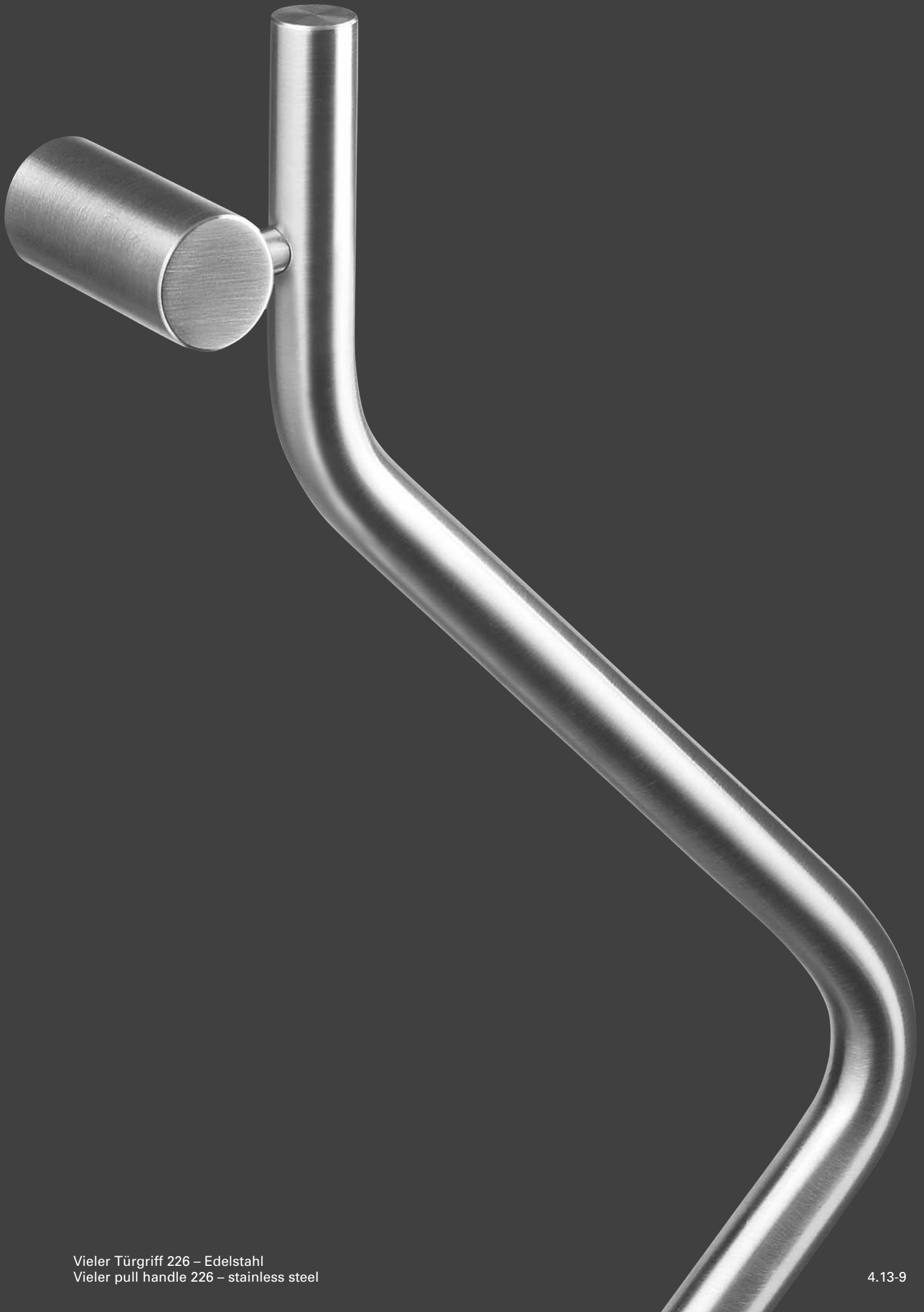

Vieler Türgriff 226 – Edelstahl
Vieler pull handle 226 – stainless steel

Vieler Türgriff 226 – Edelstahl

Hochwertiges Material mit matt gebürsteter, pflegeleichter Oberfläche. Verdeckte Beschlagverschraubung. Verarbeitungsfreundliches Befestigungsmaterial.

Vieler pull handle 226 – stainless steel

Maintenance free brushed satin stainless steel. Supplied with relevant concealed fixings.

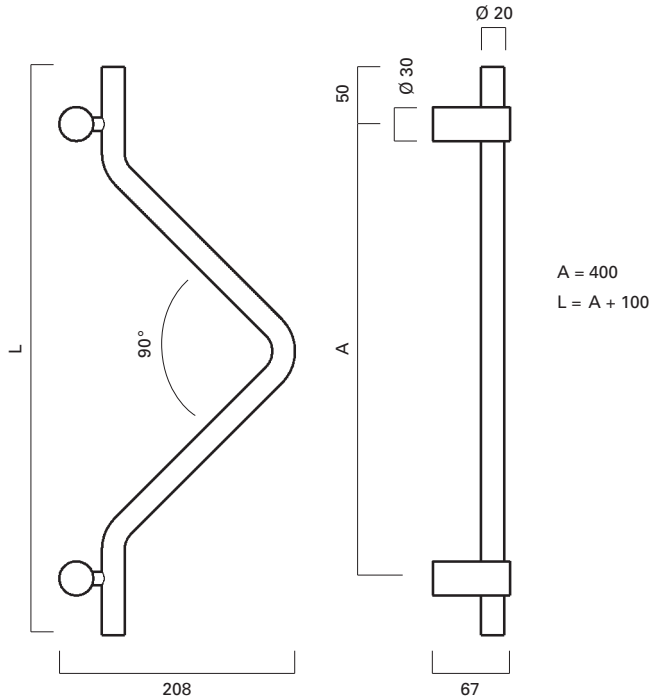

Die Befestigung des Innen-Türgriffs mit dem Gewindestift M 6 kann je nach Modell von unten, oben oder seitlich erfolgen.

The fixing of the inside pull handle with fixing bolt M 6 can occur to model from below, on top or at the side.

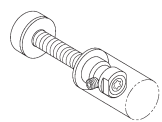

GE0
Metalltür
Metal door

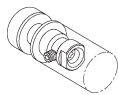

GE2
Glastür
Glass door

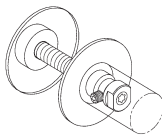

GE4
Holztür
Wooden door

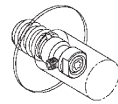

GE6
Holztür/
Einschraubmuttern
Wooden door/
threaded bush

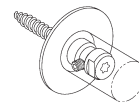

GE7
Holztür/
Holzschrauben
Wooden door/
Wood screw

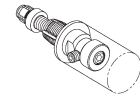

GE10
Rahmentür
mit mehreren Kammern
Metal door/
different channels

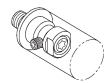

GE12
Rahmentür/
Kerneinlagen
Metal door/
solid metal core

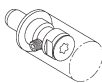

GE13
Rahmentür/
Blindnietmuttern
Metal door/
threaded bush

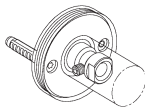

GE17
Rosettenbefestigung
Rose fixing

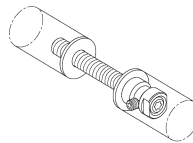

GP1
Metalltür
Metal door

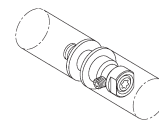

GP3
Glastür
Glass door

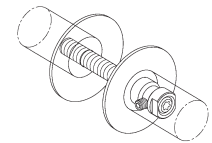

GP5
Holztür
Wooden door

Produktfamilie
Product family

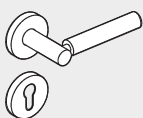

Türdrücker 121
Lever handle 121
2.06-9

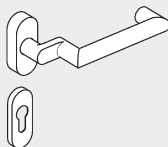

Rahmentür-Drücker RT 114
Narrow stile lever handle RT 114
2.32-9

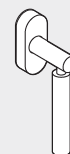

Fenstergriff 121
Window handle 121
3.03-9



Vieler Türgriff 230 / 240 – Edelstahl

Hochwertiges Material mit matt gebürsteter, pflegeleichter Oberfläche. Verdeckte Beschlagverschraubung. Verarbeitungsfreundliches Befestigungsmaterial.

Vieler pull handle 230 / 240 – stainless steel

Maintenance free brushed satin stainless steel. Supplied with relevant concealed fixings.

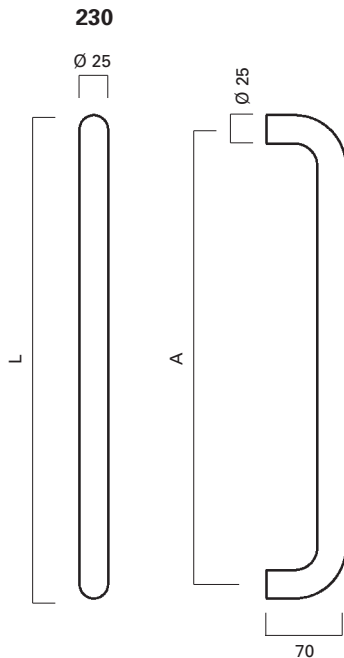

A = 300 – 1250
L = A + 25

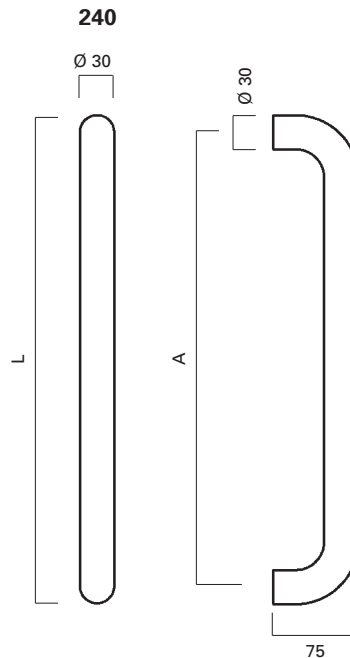

A = 300 – 1250
L = A + 30

Die Befestigung des Innentürgriffs mit dem Gewindestift M6 kann je nach Modell von unten, oben oder seitlich erfolgen.

The fixing of the inside pull handle with fixing bolt M6 can occur to model from below, on top or at the side.

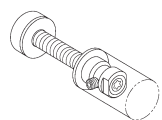

GE0
Metalltür
Metal door

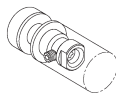

GE2
Glastür
Glass door

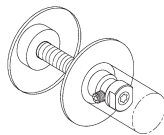

GE4
Holztür
Wooden door

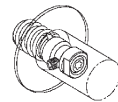

GE6
Holztür/
Einschraubmuttern
Wooden door/
threaded bush

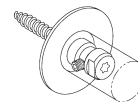

GE7
Holztür/
Holzschrauben
Wooden door/
Wood screw

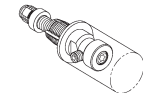

GE10
Rahmentür
mit mehreren Kammern
Metal door/
different channels

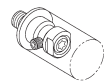

GE12
Rahmentür/
Kerneinlagen
Metal door/
solid metal core

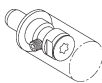

GE13
Rahmentür/
Blindnietmuttern
Metal door/
threaded bush

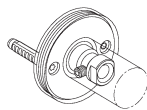

GE17
Rosettenbefestigung
Rose fixing

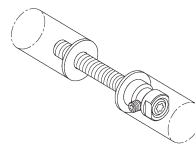

GP1
Metalltür
Metal door

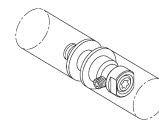

GP3
Glastür
Glass door

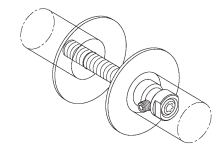

GP5
Holztür
Wooden door

Produktfamilie
Product family

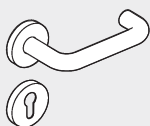

Türdrücker 522
Lever handle 522
2.17-9

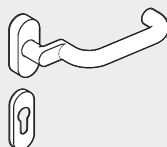

Rahmentür-Drücker RT 522
Narrow stile lever handle RT 522
2.37-9



Fenstergriff 622
Window handle 622
3.14-9



Vieler Türgriff 231 – Edelstahl
Vieler pull handle 231 – stainless steel

Vieler Türgriff 231 – Edelstahl

Hochwertiges Material mit matt gebürsteter, pflegeleichter Oberfläche. Verdeckte Beschlagverschraubung. Verarbeitungsfreundliches Befestigungsmaterial.

Vieler pull handle 231 – stainless steel

Maintenance free brushed satin stainless steel. Supplied with relevant concealed fixings.

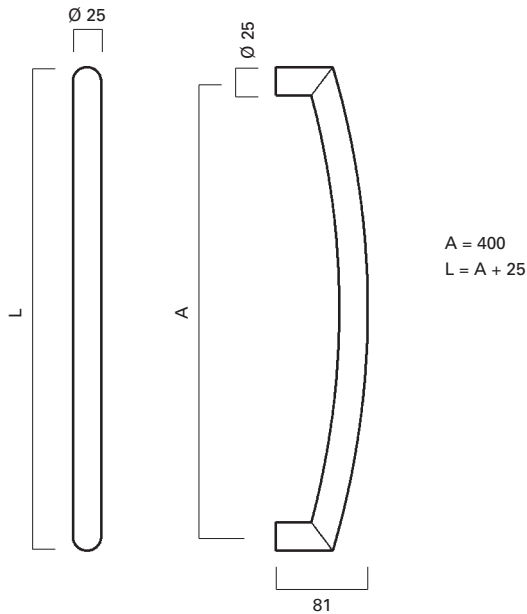

Die Befestigung des Innen-Türgriffs mit dem Gewindestift M 6 kann je nach Modell von unten, oben oder seitlich erfolgen.

The fixing of the inside pull handle with fixing bolt M 6 can occur to model from below, on top or at the side.

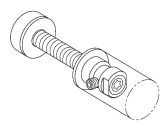

GE0
Metalltür
Metal door

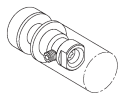

GE2
Glastür
Glass door

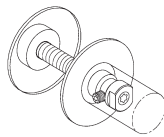

GE4
Holztür
Wooden door

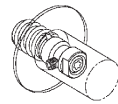

GE6
Holztür/
Einschraubmuttern
Wooden door/
threaded bush

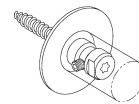

GE7
Holztür/
Holzschrauben
Wooden door/
Wood screw

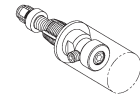

GE10
Rahmentür
mit mehreren Kammern
Metal door/
different channels

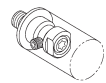

GE12
Rahmentür/
Kerneinlagen
Metal door/
solid metal core

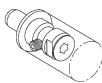

GE13
Rahmentür/
Blindnietmuttern
Metal door/
threaded bush

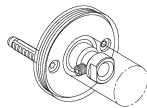

GE17
Rosettenbefestigung
Rose fixing

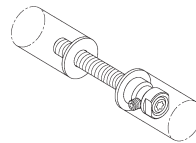

GP1
Metalltür
Metal door

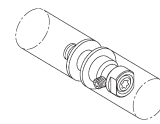

GP3
Glastür
Glass door

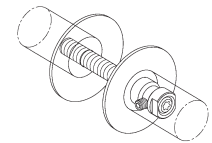

GP5
Holztür
Wooden door

Produktfamilie
Product family



Türdrücker 132
Lever handle 132
2.08-9

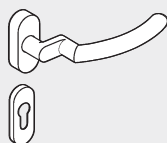

Rahmentür-Drücker RT 132
Narrow stile lever handle RT 132
2.33-9



Fenstergriff 132
Window handle 132
3.05-9



Vieler Türgriff 232 – Edelstahl
Vieler pull handle 232 – stainless steel

Vieler Türgriff 232 – Edelstahl

Hochwertiges Material mit matt gebürsteter, pflegeleichter Oberfläche. Verdeckte Beschlagverschraubung. Verarbeitungsfreundliches Befestigungsmaterial.

Vieler pull handle 232 – stainless steel

Maintenance free brushed satin stainless steel. Supplied with relevant concealed fixings.

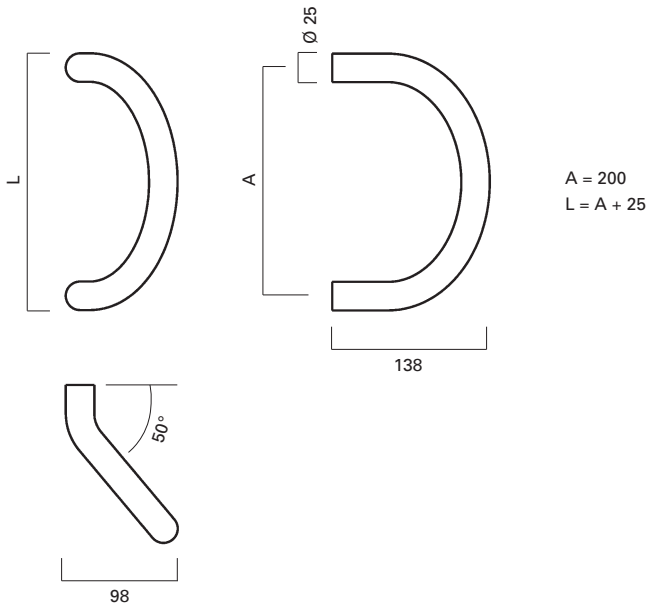

Die Befestigung des Innen-Türgriffs mit dem Gewindestift M 6 kann je nach Modell von unten, oben oder seitlich erfolgen.

The fixing of the inside pull handle with fixing bolt M 6 can occur to model from below, on top or at the side.

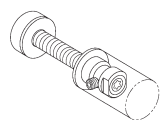

GE0
Metalltür
Metal door

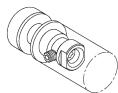

GE2
Glastür
Glass door

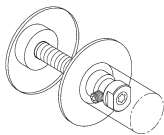

GE4
Holztür
Wooden door

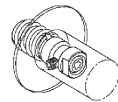

GE6
Holztür/
Einschraubmuttern
Wooden door/
threaded bush

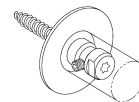

GE7
Holztür/
Holzschrauben
Wooden door/
Wood screw

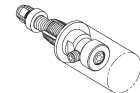

GE10
Rahmentür
mit mehreren Kammern
Metal door/
different channels



GE12
Rahmentür/
Kerneinlagen
Metal door/
solid metal core

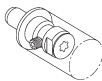

GE13
Rahmentür/
Blindnietmuttern
Metal door/
threaded bush

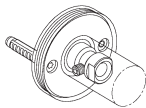

GE17
Rosettenbefestigung
Rose fixing

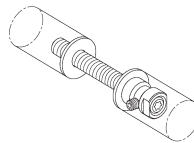

GP1
Metalltür
Metal door

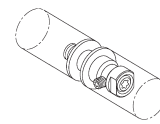

GP3
Glastür
Glass door

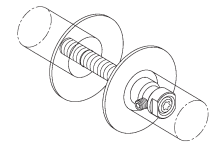

GP5
Holztür
Wooden door

Produktfamilie
Product family



Türdrücker 522
Lever handle 522
2.17-9

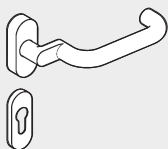

Rahmentür-Drücker RT 522
Narrow stile lever handle RT 522
2.37-9



Fenstergriff 622
Window handle 622
3.14-9



Vieler Türgriff 233 – Edelstahl
Vieler pull handle 233 – stainless steel

Vieler Türgriff 233 – Edelstahl

Hochwertiges Material mit matt gebürsteter, pflegeleichter Oberfläche. Verdeckte Beschlagverschraubung. Verarbeitungsfreundliches Befestigungsmaterial.

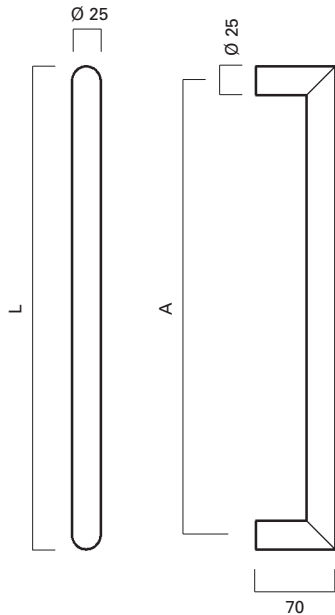

A = 400 – 1000
L = A + 25

Vieler pull handle 233 – stainless steel

Maintenance free brushed satin stainless steel. Supplied with relevant concealed fixings.

Die Befestigung des Innen-Türgriffs mit dem Gewindestift M 6 kann je nach Modell von unten, oben oder seitlich erfolgen.

The fixing of the inside pull handle with fixing bolt M 6 can occur to model from below, on top or at the side.

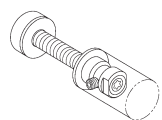

GE0
Metalltür
Metal door

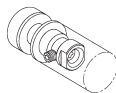

GE2
Glastür
Glass door

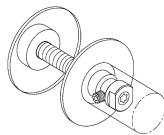

GE4
Holztür
Wooden door

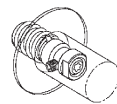

GE6
Holztür/
Einschraubmuttern
Wooden door/
threaded bush

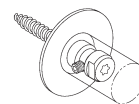

GE7
Holztür/
Holzschrauben
Wooden door/
Wood screw

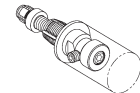

GE10
Rahmentür
mit mehreren Kammern
Metal door/
different channels

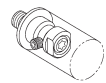

GE12
Rahmentür/
Kerneinlagen
Metal door/
solid metal core

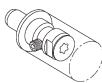

GE13
Rahmentür/
Blindnietmuttern
Metal door/
threaded bush

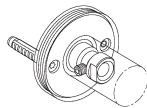

GE17
Rosettenbefestigung
Rose fixing

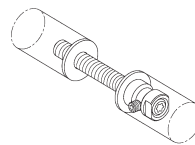

GP1
Metalltür
Metal door

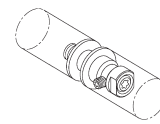

GP3
Glastür
Glass door

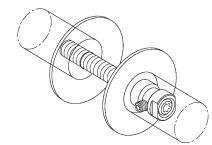

GP5
Holztür
Wooden door

Produktfamilie
Product family

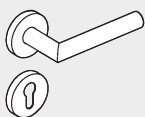

Türdrücker 112
Lever handle 112
2.03-9

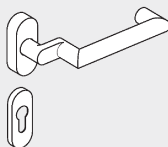

Rahmentür-Drücker RT 114
Narrow stile lever handle RT 114
2.32-9



Fenstergriff 612
Window handle 612
3.12-9



Vieler Türgriff 234 / 244 – Edelstahl

Hochwertiges Material mit matt gebürsteter, pflegeleichter Oberfläche. Verdeckte Beschlagverschraubung. Verarbeitungsfreundliches Befestigungsmaterial.

Vieler pull handle 234 / 244 – stainless steel

Maintenance free brushed satin stainless steel. Supplied with relevant concealed fixings.

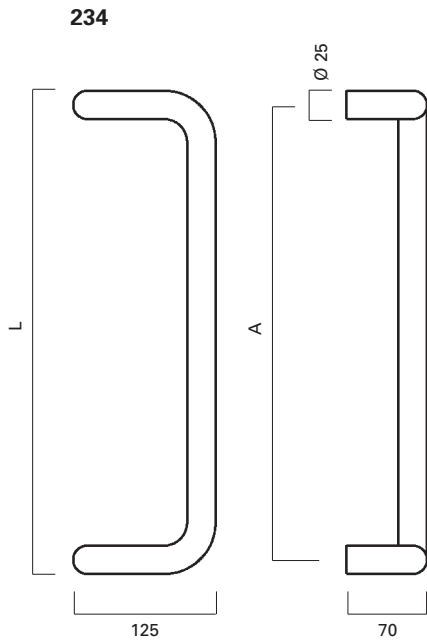

A = 300 – 1250
L = A + 25

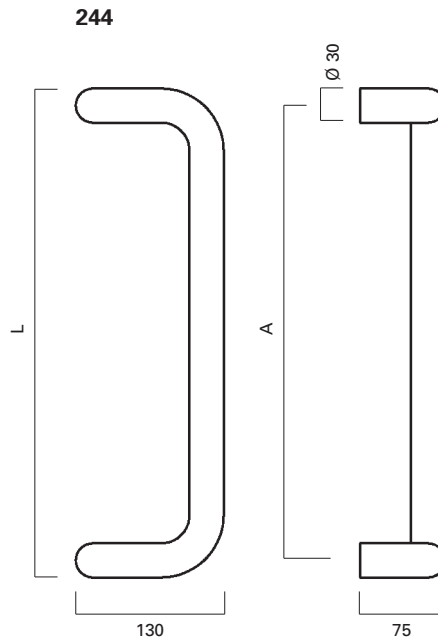

A = 300 – 1250
L = A + 30

Die Befestigung des Innen-Türgriffs mit dem Gewindestift M6 kann je nach Modell von unten, oben oder seitlich erfolgen.

The fixing of the inside pull handle with fixing bolt M6 can occur to model from below, on top or at the side.

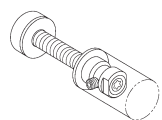

GE0
Metalltür
Metal door

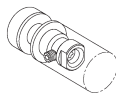

GE2
Glastür
Glass door

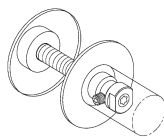

GE4
Holztür
Wooden door

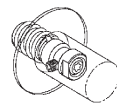

GE6
Holztür/
Einschraubmuttern
Wooden door/
threaded bush

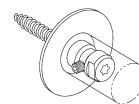

GE7
Holztür/
Holzschrauben
Wooden door/
Wood screw

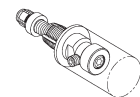

GE10
Rahmentür
mit mehreren Kammern
Metal door/
different channels

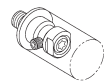

GE12
Rahmentür/
Kerneinlagen
Metal door/
solid metal core

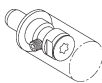

GE13
Rahmentür/
Blindnietmuttern
Metal door/
threaded bush

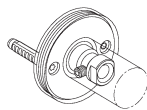

GE17
Rosettenbefestigung
Rose fixing

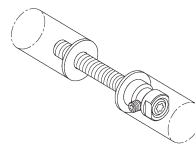

GP1
Metalltür
Metal door

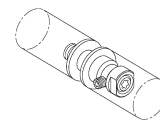

GP3
Glastür
Glass door

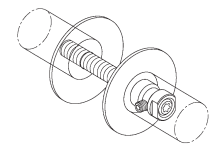

GP5
Holztür
Wooden door

Produktfamilie
Product family



Türdrücker 522
Lever handle 522
2.17-9

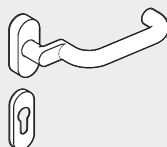

Rahmentür-Drücker RT 522
Narrow stile lever handle RT 522
2.37-9



Fenstergriff 622
Window handle 622
3.14-9

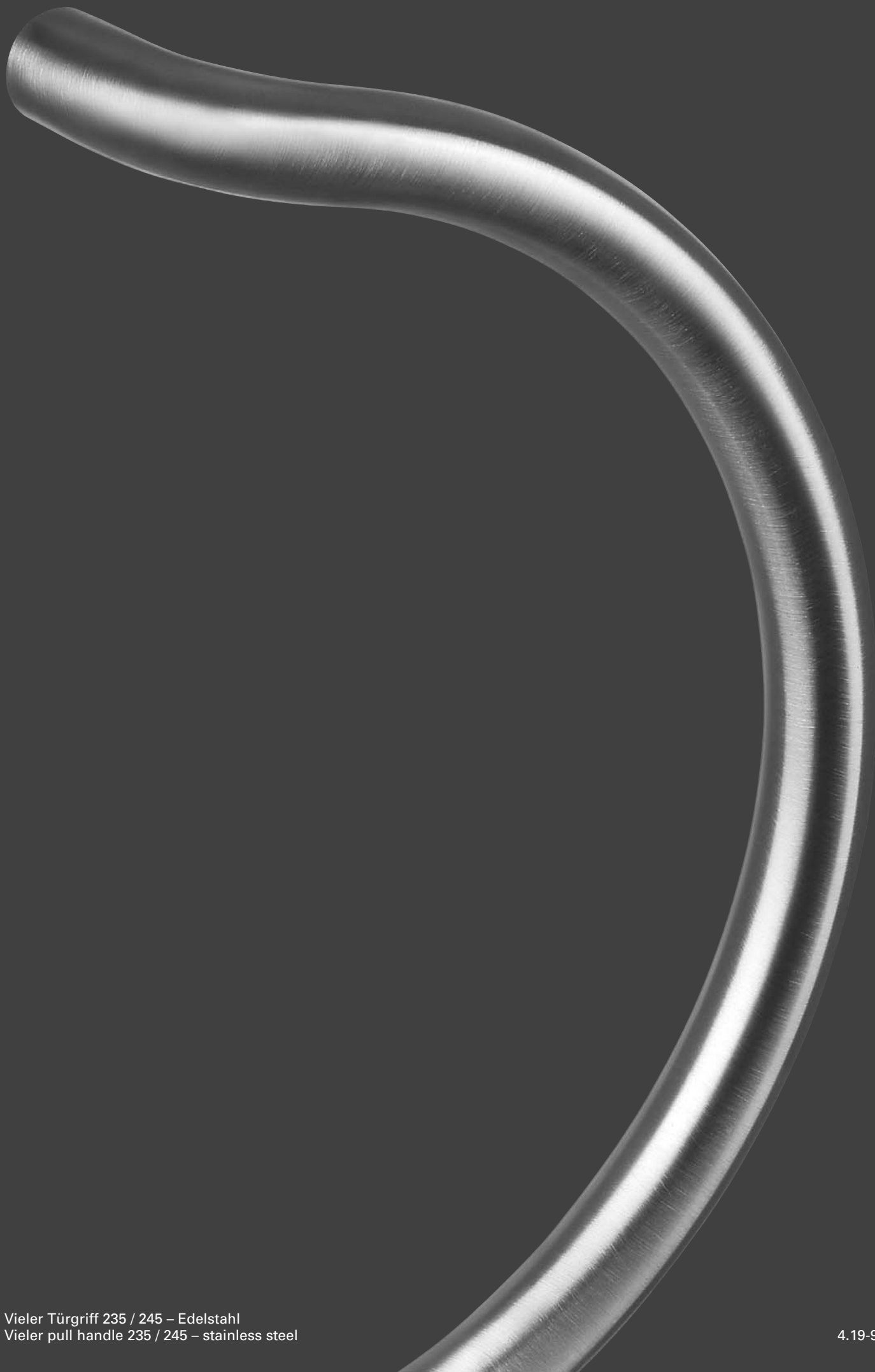

Vieler Türgriff 235 / 245 – Edelstahl

Hochwertiges Material mit matt gebürsteter, pflegeleichter Oberfläche. Verdeckte Beschlagverschraubung. Verarbeitungsfreundliches Befestigungsmaterial.

Vieler pull handle 235 / 245 – stainless steel

Maintenance free brushed satin stainless steel. Supplied with relevant concealed fixings.

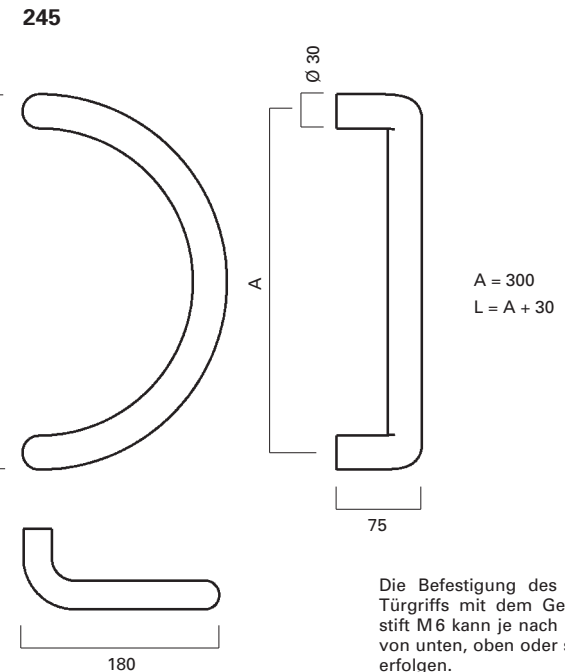
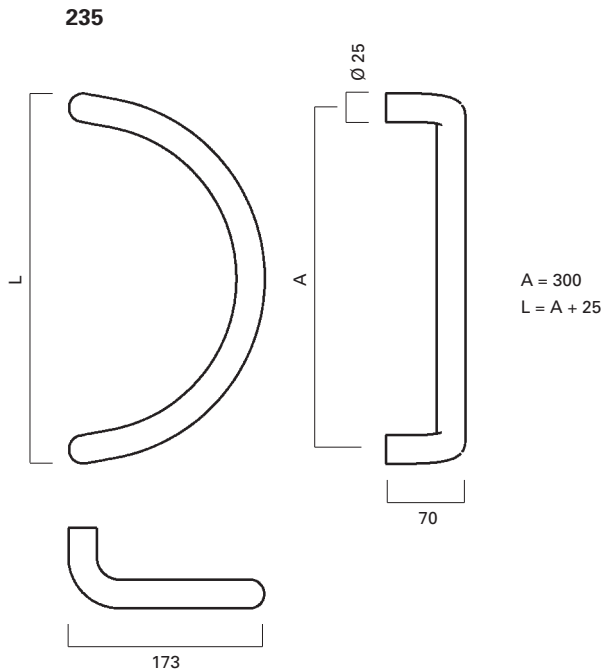

Die Befestigung des Innentürgriffs mit dem Gewindestift M6 kann je nach Modell von unten, oben oder seitlich erfolgen.

The fixing of the inside pull handle with fixing bolt M6 can occur to model from below, on top or at the side.

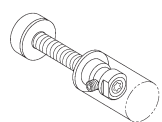

GE0
Metalltür
Metal door

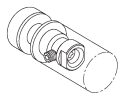

GE2
Glastür
Glass door

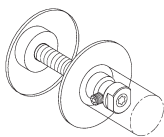

GE4
Holztür
Wooden door

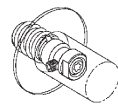

GE6
Holztür/
Einschraubmuttern
Wooden door/
threaded bush

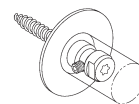

GE7
Holztür/
Holzschrauben
Wooden door/
Wood screw

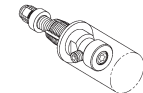

GE10
Rahmentür
mit mehreren Kammern
Metal door/
different channels

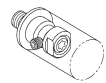

GE12
Rahmentür/
Kerneinlagen
Metal door/
solid metal core

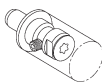

GE13
Rahmentür/
Blindnietmuttern
Metal door/
threaded bush

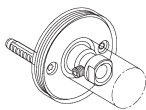

GE17
Rosettenbefestigung
Rose fixing

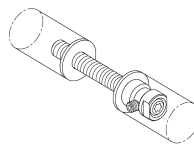

GP1
Metalltür
Metal door

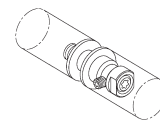

GP3
Glastür
Glass door

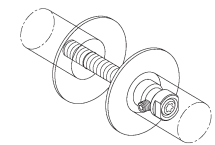

GP5
Holztür
Wooden door

Produktfamilie
Product family



Türdrücker 522
Lever handle 522
2.17-9

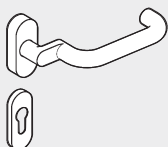

Rahmentür-Drücker RT 522
Narrow stile lever handle RT 522
2.37-9



Fenstergriff 622
Window handle 622
3.14-9



Vieler Türgriff 239 – Edelstahl
Vieler pull handle 239 – stainless steel

Vieler Türgriff 239 – Edelstahl

Hochwertiges Material mit matt gebürsteter, pflegeleichter Oberfläche. Verdeckte Beschlagverschraubung. Verarbeitungsfreundliches Befestigungsmaterial.

Vieler pull handle 239 – stainless steel

Maintenance free brushed satin stainless steel. Supplied with relevant concealed fixings.

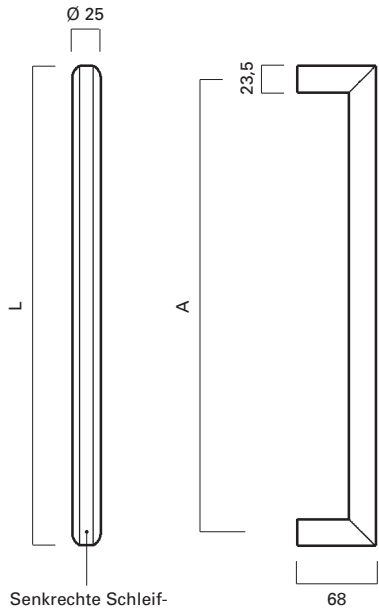

A = 400
L = A + 22
L max. = 840

Senkrechte Schleifrichtung der Fläche
Vertical grinding

Die Befestigung des Innen-Türgriffs mit dem Gewindestift M 6 kann je nach Modell von unten, oben oder seitlich erfolgen.

The fixing of the inside pull handle with fixing bolt M 6 can occur to model from below, on top or at the side.

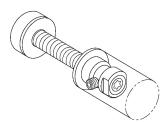

GE0
Metalltür
Metal door

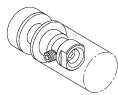

GE2
Glastür
Glass door

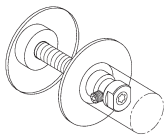

GE4
Holztür
Wooden door

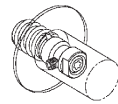

GE6
Holztür/
Einschraubmuttern
Wooden door/
threaded bush

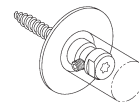

GE7
Holztür/
Holzschrauben
Wooden door/
Wood screw

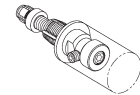

GE10
Rahmentür
mit mehreren Kammern
Metal door/
different channels

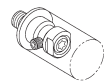

GE12
Rahmentür/
Kerneinlagen
Metal door/
solid metal core

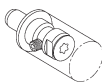

GE13
Rahmentür/
Blindnietmuttern
Metal door/
threaded bush

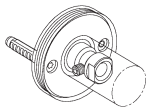

GE17
Rosettenbefestigung
Rose fixing

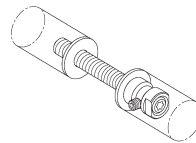

GP1
Metalltür
Metal door

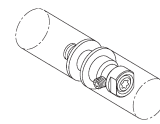

GP3
Glastür
Glass door

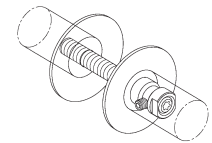

GP5
Holztür
Wooden door

Produktfamilie
Product family

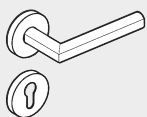

Türdrücker 135
Lever handle 135
2.11-9

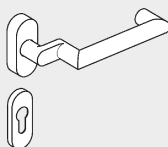

Rahmentür-Drücker RT 114
Narrow stile lever handle RT 114
2.32-9



Fenstergriff 135
Window handle 135
3.08-9



Vieler Türgriff 250 – Edelstahl
Vieler pull handle 250 – stainless steel

Vieler Türgriff 250 – Edelstahl

Hochwertiges Material mit matt gebürsteter, pflegeleichter Oberfläche. Verdeckte Beschlagverschraubung. Verarbeitungsfreundliches Befestigungsmaterial.

Vieler pull handle 250 – stainless steel

Maintenance free brushed satin stainless steel. Supplied with relevant concealed fixings.

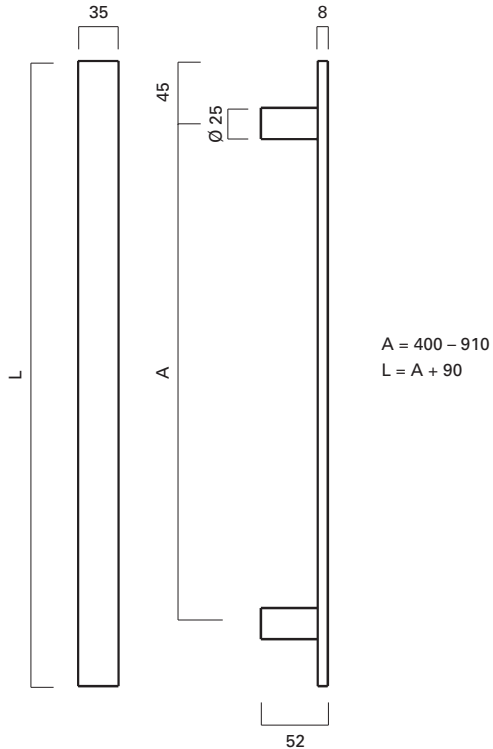

Die Befestigung des Innen-Türgriffs mit dem Gewindestift M6 kann je nach Modell von unten, oben oder seitlich erfolgen.

The fixing of the inside pull handle with fixing bolt M6 can occur to model from below, on top or at the side.

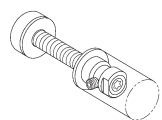

GE0
Metalltür
Metal door

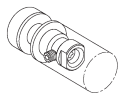

GE2
Glastür
Glass door

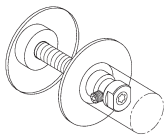

GE4
Holztür
Wooden door

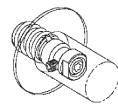

GE6
Holztür/
Einschraubmuttern
Wooden door/
threaded bush

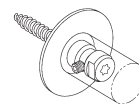

GE7
Holztür/
Holzschrauben
Wooden door/
Wood screw

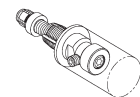

GE10
Rahmentür
mit mehreren Kammern
Metal door/
different channels

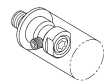

GE12
Rahmentür/
Kerneinlagen
Metal door/
solid metal core

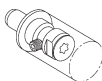

GE13
Rahmentür/
Blindnietmuttern
Metal door/
threaded bush

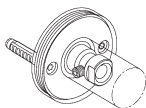

GE17
Rosettenbefestigung
Rose fixing

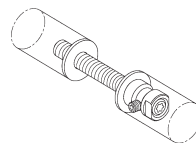

GP1
Metalltür
Metal door

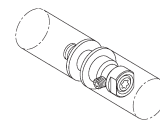

GP3
Glastür
Glass door

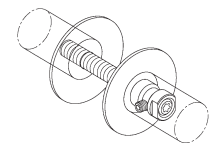

GP5
Holztür
Wooden door

Produktfamilie
Product family

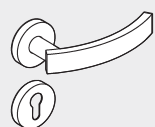

Türdrücker 804
Lever handle 804
2.23-9

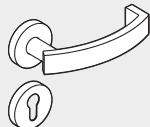

Türdrücker 805
Lever handle 805
2.24-9

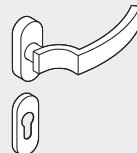

Rahmentür-Drücker RT 806
Narrow stile lever handle RT 806
2.39-9



Fenstergriff 804
Window handle 804
3.16-9



Vieler Türgriff 251 – Edelstahl
Vieler pull handle 251 – stainless steel

Vieler Türgriff 251 – Edelstahl

Hochwertiges Material mit matt gebürsteter, pflegeleichter Oberfläche. Verdeckte Beschlagverschraubung. Verarbeitungsfreundliches Befestigungsmaterial.

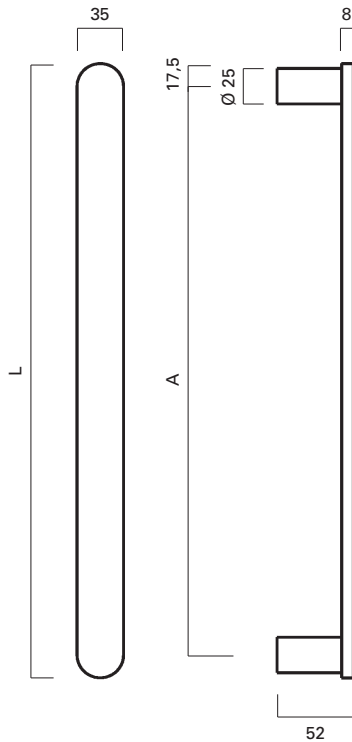

A = 400 – 965
L = A + 35

Vieler pull handle 251 – stainless steel

Maintenance free brushed satin stainless steel. Supplied with relevant concealed fixings.

Die Befestigung des Innen-Türgriffs mit dem Gewindestift M 6 kann je nach Modell von unten, oben oder seitlich erfolgen.

The fixing of the inside pull handle with fixing bolt M 6 can occur to model from below, on top or at the side.

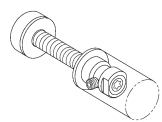

GE0
Metalltür
Metal door

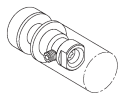

GE2
Glastür
Glass door

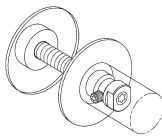

GE4
Holztür
Wooden door

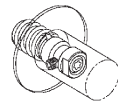

GE6
Holztür/
Einschraubmuttern
Wooden door/
threaded bush

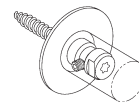

GE7
Holztür/
Holzschrauben
Wooden door/
Wood screw

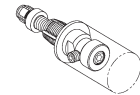

GE10
Rahmentür
mit mehreren Kammern
Metal door/
different channels

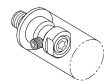

GE12
Rahmentür/
Kerneinlagen
Metal door/
solid metal core

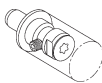

GE13
Rahmentür/
Blindnietmuttern
Metal door/
threaded bush

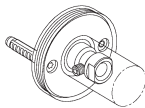

GE17
Rosettenbefestigung
Rose fixing

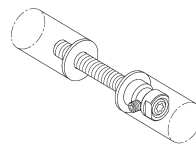

GP1
Metalltür
Metal door

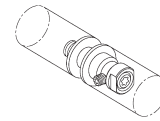

GP3
Glastür
Glass door

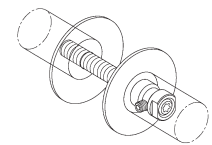

GP5
Holztür
Wooden door

Produktfamilie
Product family

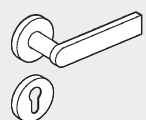

Türdrücker 801
Lever handle 801
2.21-9

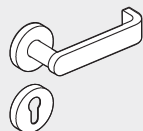

Türdrücker 802
Lever handle 802
2.22-9

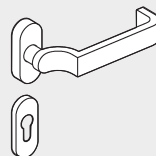

Rahmentür-Drücker RT 803
Narrow stile lever handle RT 803
2.38-9



Fenstergriff 801
Window handle 801
3.15-9

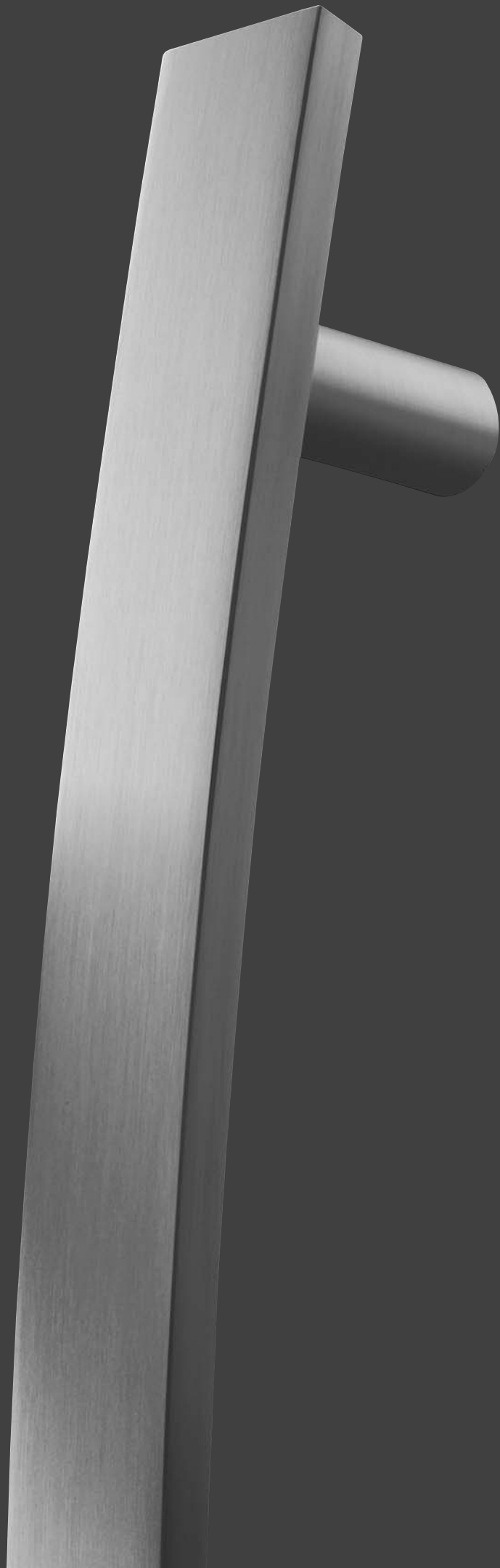

Vieler Türgriff 252 – Edelstahl
Vieler pull handle 252 – stainless steel

Vieler Türgriff 252 – Edelstahl

Hochwertiges Material mit matt gebürsteter, pflegeleichter Oberfläche. Verdeckte Beschlagverschraubung. Verarbeitungsfreundliches Befestigungsmaterial.

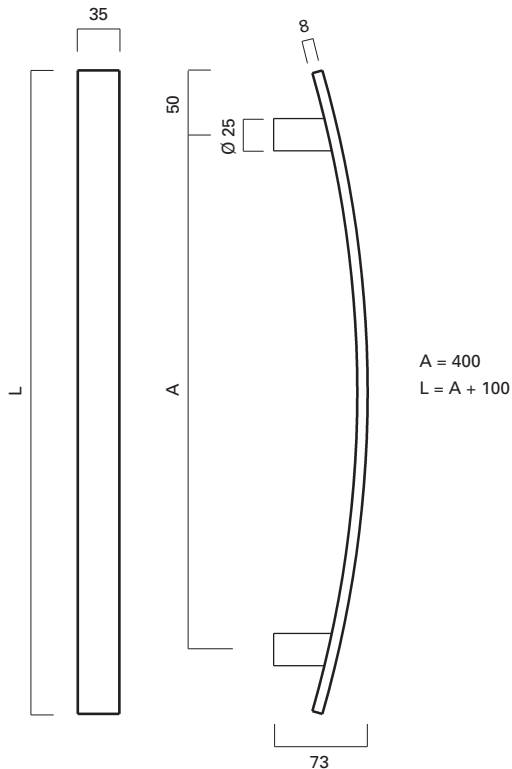

Vieler pull handle 252 – stainless steel

Maintenance free brushed satin stainless steel. Supplied with relevant concealed fixings.

Die Befestigung des Innen-Türgriffs mit dem Gewindestift M 6 kann je nach Modell von unten, oben oder seitlich erfolgen.

The fixing of the inside pull handle with fixing bolt M 6 can occur to model from below, on top or at the side.

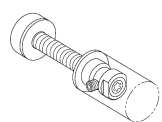

GE0
Metalltür
Metal door

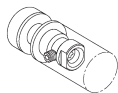

GE2
Glastür
Glass door

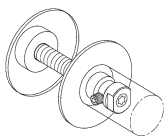

GE4
Holztür
Wooden door

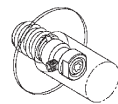

GE6
Holztür/
Einschraubmuttern
Wooden door/
threaded bush

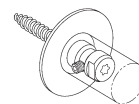

GE7
Holztür/
Holzschrauben
Wooden door/
Wood screw

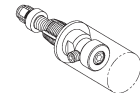

GE10
Rahmentür
mit mehreren Kammern
Metal door/
different channels

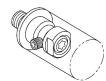

GE12
Rahmentür/
Kerneinlagen
Metal door/
solid metal core

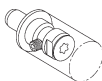

GE13
Rahmentür/
Blindnietmuttern
Metal door/
threaded bush

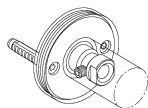

GE17
Rosettenbefestigung
Rose fixing

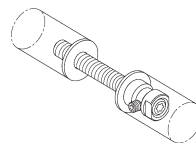

GP1
Metalltür
Metal door

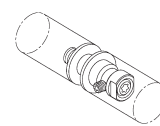

GP3
Glastür
Glass door

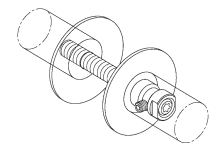

GP5
Holztür
Wooden door

Produktfamilie
Product family

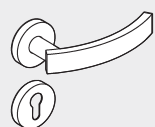

Türdrücker 804
Lever handle 804
2.23-9

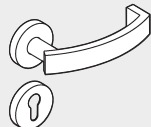

Türdrücker 805
Lever handle 805
2.24-9

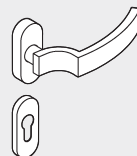

Rahmentür-Drücker RT 806
Narrow stile lever handle RT 806
2.39-9



Fenstergriff 804
Window handle 804
3.16-9



Vieler Türgriff 253 – Edelstahl

Hochwertiges Material mit matt gebürsteter, pflegeleichter Oberfläche. Verdeckte Beschlagverschraubung. Verarbeitungsfreundliches Befestigungsmaterial.

Vieler pull handle 253 – stainless steel

Maintenance free brushed satin stainless steel. Supplied with relevant concealed fixings.

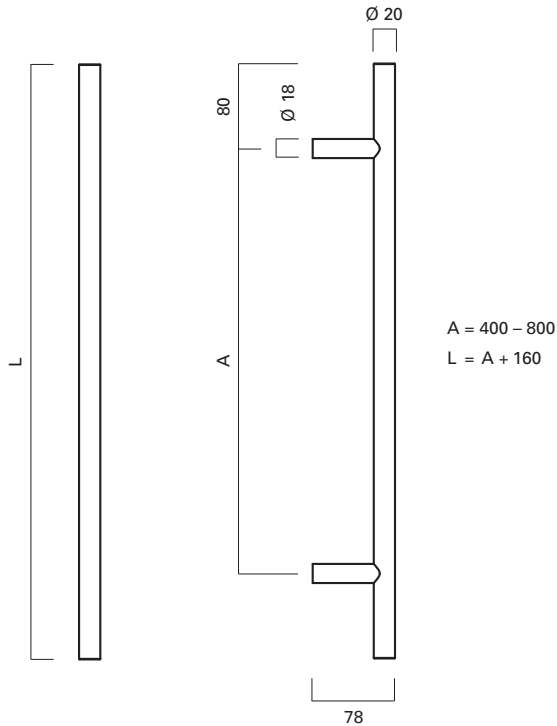

Die Befestigung des Innen-Türgriffs mit dem Gewindestift M 6 kann je nach Modell von unten, oben oder seitlich erfolgen.

The fixing of the inside pull handle with fixing bolt M 6 can occur to model from below, on top or at the side.

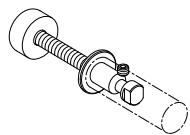

GE0.1
Metall- und Holztür
Metal door and wooden door

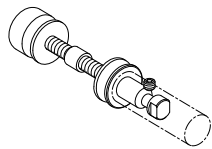

GE2.1
Glastür
Glass door

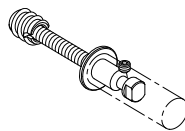

GE6.1
Holztür/
Einschraubmuttern
Wooden door/
threaded bush

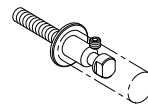

GE12.1
Rahmentür/
Kerneinlagen
Metal door/
solid metal core

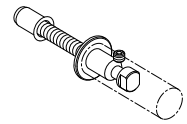

GE13.1
Rahmentür/
Blindnietmuttern
Metal door/
threaded bush

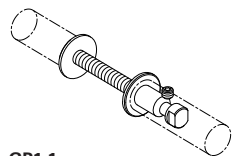

GP1.1
Metall- und Holztür
Metal door and wooden door

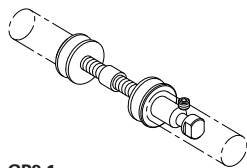

GP3.1
Glastür
Glass door

Alle Befestigungsarten mit Gewindestift M 8
All types of fixing including grub screws M 8

Produktfamilie
Product family

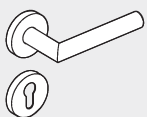

Türdrücker 112
Lever handle 112
2.03-9

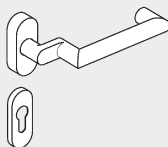

Rahmentür-Drücker RT 114
Narrow stile lever handle RT 114
2.32-9



Fenstergriff 612
Window handle 612
3.12-9